

Town of Dewey Year 2030 Comprehensive Plan

Contents

	Page
1. Issues and Opportunities	1-1
1.1 Introduction.....	1-1
1.2 Plan Summary	1-2
1.3 Town of Dewey 2030 Vision.....	1-4
1.4 Comprehensive Plan Development Process and Public Participation	1-7
1.5 Town of Dewey Issues and Opportunities	1-8
1.6 Issues and Opportunities Policies and Recommendations.....	1-11
2. Population and Housing	2-1
2.1 Population and Housing Plan.....	2-1
2.2 Population Characteristics Summary	2-1
2.3 Housing Characteristics Summary.....	2-5
2.4 Population and Housing Trends and Outlook.....	2-8
2.5 Housing for All Income Levels.....	2-8
2.6 Housing for All Age Groups and Persons with Special Needs.....	2-9
2.7 Promoting Availability of Land for Development/Redevelopment of Low-Income and Moderate-Income Housing	2-9
2.8 Maintaining and Rehabilitating the Existing Housing Stock.....	2-10
2.9 Population and Housing Goals and Objectives.....	2-10
2.10 Population and Housing Policies and Recommendations.....	2-11
2.11 Population and Housing Programs.....	2-12
3. Transportation	3-1
3.1 Transportation Plan.....	3-1
3.2 Planned Transportation Improvements	3-2
3.3 Comparison with County, State, and Regional Transportation Plans.....	3-2
3.4 Transportation Goals and Objectives.....	3-2
3.5 Transportation Policies and Recommendations.....	3-4
3.6 Transportation Programs.....	3-6
4. Utilities and Community Facilities.....	4-1
4.1 Utilities and Community Facilities Plan	4-1
4.2 Planned Utility and Community Facility Improvements	4-5
4.3 Utilities and Community Facilities Goals and Objectives	4-11
4.4 Utilities and Community Facilities Policies and Recommendations	4-12
4.5 Utilities and Community Facilities Programs	4-14
5. Agricultural, Natural, and Cultural Resources	5-1
5.1 Agricultural, Natural, and Cultural Resources Plan.....	5-1
5.2 Agricultural, Natural, and Cultural Resources Goals and Objectives	5-3
5.3 Agricultural, Natural, and Cultural Resources Policies and Recommendations	5-6

5.4	Agriculture, Natural, and Cultural Resources Programs	5-9
6.	Economic Development	6-1
6.1	Economic Development Plan.....	6-1
6.2	Economic Characteristics Summary	6-2
6.3	Desired Business and Industry	6-5
6.4	Sites for Business and Industrial Development	6-6
6.5	Economic Development Goals and Objectives.....	6-6
6.6	Economic Development Policies and Recommendations.....	6-8
6.7	Economic Development Programs	6-10
7.	Intergovernmental Cooperation.....	7-1
7.1	Intergovernmental Cooperation Plan	7-1
7.2	Inventory of Existing Intergovernmental Agreements	7-1
7.3	Analysis of the Relationship with School Districts and Adjacent Local Governmental Units.....	7-2
7.4	Intergovernmental Opportunities, Conflicts, and Resolutions.....	7-3
7.5	Intergovernmental Cooperation Goals and Objectives	7-7
7.6	Intergovernmental Cooperation Policies and Recommendations	7-7
7.7	Intergovernmental Cooperation Programs	7-9
8.	Land Use.....	8-1
8.1	Introduction.....	8-1
8.2	Existing Land Use.....	8-1
8.3	Land Ownership and Management	8-6
8.4	Projected Supply and Demand of Land Uses	8-7
8.5	Density Management - A Different Approach to Managing Development.....	8-9
8.6	Cluster/Conservation Development.....	8-10
8.7	Future Land Use Plan.....	8-10
8.8	Future Land Use Management Areas	8-14
8.9	Existing and Potential Land Use Conflicts	8-20
8.10	Opportunities for Redevelopment.....	8-21
8.11	Land Use Goals and Objectives	8-21
8.12	Land Use Policies and Recommendations	8-23
8.13	Land Use Programs.....	8-26
9.	Implementation.....	9-1
9.1	Action Plan.....	9-1
9.2	Status and Changes to Land Use Programs and Regulations	9-5
9.3	Non-Regulatory Land Use Management Tools	9-18
9.4	Comprehensive Plan Amendments and Updates	9-19
9.5	Integration and Consistency of Planning Elements	9-20
9.6	Measurement of Plan Progress.....	9-22
9.7	Implementation Goals and Objectives	9-23
9.8	Implementation Policies and Recommendations	9-24

Tables

Table 1-1	Issues and Opportunities Identification Town of Dewey	1-8
Table 2-1	Population Counts, Burnett County, 1970-2008	2-3

Table 2-2	Housing Supply, Occupancy, and Tenure, Town of Dewey, 1990 and 2000	2-5
Table 2-3	Housing Supply, Occupancy, and Tenure, Burnett County, 1990 and 2000	2-5
Table 6-1	Educational Attainment of Persons Age 25 and Over, Burnett County and Town of Dewey, 2000	6-3
Table 6-2	Employment by Industry, Town of Dewey, Burnett County, and Wisconsin, 2000	6-4
Table 6-3	Employment by Occupation, Town of Dewey, Burnett County, and Wisconsin, 2000	6-5
Table 8-1	Existing Land Use, Town of Dewey, 2008	8-2
Table 8-2	Land Ownership and Management.....	8-7
Table 8-3	Projected Land Use Demand (acres) Town of Dewey, 2000-2037	Error! Bookmark not defined.
Table 8-4	Land Supply and Demand Comparison Town of Dewey.....	Error! Bookmark not defined.
Table 8-5	Future Land Use, Town of Dewey, 2008	Error! Bookmark not defined.
Table 9-1	Zoning Districts, Town of Dewey, 2009	9-6

Figures

Figure 2-1	Population, Town of Dewey, 1970-2008	2-2
Figure 2-2	Comparative Population Forecast, 2008-2030 Town of Dewey Population Forecasts	2-4
Figure 2-3	Units in Structure, Town of Dewey, 2000	2-6
Figure 2-4	Comparative Housing Forecast, 2000-2030	Error! Bookmark not defined.
Figure 8-1	Existing Land Use, Town of Dewey, 2004.....	8-2
Figure 8-2	Land Supply and Demand Comparison Town of Dewey	8-9
Figure 8-3	Future Land Use, Town of Dewey, 2008.....	8-20

Maps

Map 4-1	Existing Community Facilities, Services, and Transportation	4-3
Map 4-2	Planned Community Facility and Transportation Improvements	4-9
Map 8-1	Existing Land Use	8-4
Map 8-2	Future Land Use	8-12
Map 9-1	Existing Land Use Regulations	9-8

Appendices

Public Participation Plan and Survey Results

Appendix A

Element Abbreviations

IO	Issues and Opportunities
H	Population and Housing
T	Transportation
UCF	Utilities and Community Facilities
ANC	Agricultural, Natural, and Cultural Resources
ED	Economic Development
IC	Intergovernmental Cooperation
LU	Land Use
I	Implementation

1. Issues and Opportunities

1.1 Introduction

The Town of Dewey is defined by the people who live and work there, the houses and businesses, the parks and natural features, its past, its present, and its future. No matter the location, change is the one certainty that visits all places. No community is immune to its effects. How a community changes, how that change is perceived, and how change is managed are the subjects of community comprehensive planning. An understanding of both the town's history and its vision for the future is essential to making sound decisions. The foundation of comprehensive planning relies on a balance between the past, present, and future by addressing four fundamental questions:

1. Where is the community now?
2. How did the community get here?
3. Where does the community want to be in the future?
4. How does the community get to where it wants to be?

The *Town of Dewey Year 2030 Comprehensive Plan* will guide community decision making in the Town of Dewey for the next 20 to 25 years. The town's complete comprehensive plan is composed of two documents. This *Plan Recommendations Report* contains the results of the town's decision making process as expressed by goals, objectives, policies, and recommendations. The *Inventory and Trends Report* is the second component of the comprehensive plan and contains all of the background data for Burnett County and the Town of Dewey. Both documents follow the same basic structure by addressing nine comprehensive planning elements in chapters one through nine:

1. Issues and Opportunities
2. Population and Housing
3. Transportation
4. Utilities and Community Facilities
5. Agricultural, Natural, and Cultural Resources
6. Economic Development
7. Intergovernmental Cooperation
8. Land Use
9. Implementation

Burnett County began a multi-jurisdictional planning effort in 2008 after being awarded a Comprehensive Planning Grant by the Wisconsin Department of Administration. The Town of Dewey joined Burnett County in this effort along with 10 other towns, and two villages for a total of 14 participating units of government. For more information on the multi-jurisdictional planning process, please refer to Chapter 1 of the *Inventory and Trends Report*.

The *Town of Dewey Year 2030 Comprehensive Plan* meets the requirements of Wisconsin's Comprehensive Planning law, Wisconsin Statutes 66.1001. This law requires all municipalities (counties, villages, towns, and villages) to adopt a comprehensive plan by the year 2010 if they

wish to make certain land use decisions. After the year 2010, any municipality that regulates land use must make their zoning, land division, shoreland and floodplain zoning, and official mapping decisions in a manner that is consistent with the community's comprehensive plan.

The Town of Dewey developed this comprehensive plan in response to the issues it must address and the opportunities it wishes to pursue. The Issues and Opportunities element of the comprehensive plan provides perspective on the planning process, public participation, trends and forecasts, and the overall goals of the community.

1.2 Plan Summary

The Town of Dewey is an unincorporated town in southeast Burnett County. There are no incorporated villages within the town, and the Town is situated between three villages: the Village of Siren in Burnett County and the Villages of Spooner and Shell Lake in Washburn County. Please reference Map 1-1 for the regional setting.

With a year-round population of about 605 and a low population density, the Town of Dewey can best be described as rural. As is typical in Burnett County, the landscape is characterized mainly by its natural features including large tracts of wetlands and woodlands, and by its surface water which includes ~~X~~ named lakes. Residential development is primarily clustered around the town's water resources, with a scattering of development along the existing road network. Importantly, nearly three-quarters of homes in the Town of Dewey are seasonal residences. The population is expected to remain steady, with the Wisconsin Department of Administration projecting an increase of about 4 persons a year. Future development is also projected to remain steady, with an increase of 2 houses per year. Residential housing is the primary form of projected future development.

Comment [SSM1]: Update with data from housing projection section

Public participation during the planning process identified the town's primary concerns and areas to be addressed by its comprehensive plan. Top issues and opportunities as identified by the planning committee and town citizens include the protection of natural resources and rural character, the need for improved land use planning and managing rural development regulation, and pursuing opportunities for economic development. Town of Dewey residents responded to two planning process surveys, and the strongest areas of consensus include the following:

- ♦ Providing quality, but cost-effective, services
- ♦ Finding appropriate funding mechanisms to pay for services
- ♦ Preserving natural resources and the rural character

The Town of Dewey Year 2030 Comprehensive Plan sets the stage to successfully balance and achieve results based on the community's vision.

The Town of Dewey Year 2030 Comprehensive Plan sets the stage to successfully balance and achieve the desires expressed in the goals, objectives, policies and recommendations found in this document. This will be accomplished by creating an improved system in which development takes place. This will incorporate many innovative techniques involving development density and lot size management as well as creative subdivision design. Paramount in the plan is the careful placement of residential development with regard to the community's natural features and infrastructure investments. The town's plan

will help achieve a desirable future by directing the most intensive development to areas that are suitable for such development. The overall intent is to preserve the features, character, and opportunity that the residents of Dewey enjoy today while managing the long term physical development in concert with the market forces and land use regulation that shape it. The best agricultural lands, natural resource rich areas, and areas that support outdoor recreation opportunities will be preserved as such for future generations, but will still allow development at lower densities.

1.3 Town of Dewey 2030 Vision

The Town of Dewey planning committee developed a vision statement as a part of the comprehensive planning process. Based on the town's highest priority issues and opportunities, the group identified what they would like to change, create, or preserve for the future of their community. The vision statement then expresses which issues are the most important for the town to resolve and which opportunities are most important to pursue over the long term.

Vision Statement

It is the year 2030. In the Town of Dewey we have...

1.

2.

The Town of Dewey's vision for the future is further expressed in its goal statements for each of the comprehensive planning elements. The town's planning goals are broad statements of community values and public preferences for the long term (20 years or more). Implementation of this comprehensive plan will result in the achievement of these goals by the year 2030. For further detail on these goals, including related objectives, refer to the respective element of this comprehensive plan.

Housing Goals

Goal 1: To guide new housing development into areas that can be efficiently served in a fashion that does not impact scarce natural resources.

Goal 2: Support housing development that maintains the attractiveness and rural character of the county.

Transportation Goals

Goal 1: Provide for a Safe, Efficient, and Environmentally Sound Transportation System which, through its location, capacity, and design, will effectively serve the existing land use development pattern and meet anticipated transportation demand generated by existing and planned land uses.

Goal 2: To support the efforts of villages and towns within the County to provide safe and efficient multi-modal transportation systems where appropriate.

Goal 3: Promote cooperation and coordination between state, county, towns, and villages in developing the County transportation system.

Utilities and Community Facilities Goals

Goal 1: Support the efficiency, quality, and coordinated planning of county government, community facilities and services, and utilities.

Goal 2: Provide quality and accessible parks and recreational facilities.

Agricultural, Natural, and Cultural Resources Goals

Agricultural Resources

Goal 1: Maintain the viability, operational efficiency, and productivity of the county's agricultural resources for current and future generations.

Goal 2: Balance the protection of farmland with the exercise of development rights.

Natural Resources

Goal 3: Encourage the efficient management of the County's natural resources.

Goal 4: Balance future development with the protection of natural resources.

Goal 5: Protect air quality.

Goal 6: Preserve and protect woodlands and forest resources for their economic, aesthetic, and environmental values.

Goal 7: Balance future needs for the extraction of mineral resources with potential adverse impacts on Burnett County.

Cultural Resources

Goal 8: Preserve the Northwoods character as defined by scenic beauty, a variety of landscapes, undeveloped lands, forests, water resources, wildlife, farms, rural and small town atmosphere, buildings integrated with the landscape, and enjoyment of these surroundings.

Goal 9: Strengthen opportunities for youth in Burnett County including youth-oriented activities and facilities and additional job opportunities.

Economic Development Goals

Goal 1: Maintain and enhance opportunities for resource based industries dependent on rural lands and provide opportunity for compatible economic growth and development

Goal 2: Help provide sufficient commercial and industrial lands adjacent to public facilities and transportation services that are cost effective and environmentally compatible.

Goal 3: Maintain the utility, communication, and transportation infrastructure systems that promote economic development.

Goal 4: Maintain a quality workforce to strengthen existing businesses and maintain a high standard of living.

Intergovernmental Cooperation Goals

Goal 1: Foster the growth of mutually beneficial intergovernmental relations between Burnett County and other units of government.

Goal 2: Foster the growth of mutually beneficial intergovernmental relations between local units of government within and outside of Burnett County.

Land Use Goals

Goal 1: Guide the efficient use of land through a unified vision of planned growth in recognition of resource limitations and County goals and objectives.

Goal 2: Plan for a desirable pattern of land use that contributes to the realization of the county's, towns', and villages' goals and objectives for the future.

Implementation Goals

Goal 1: Promote consistent integration of the comprehensive plan policies and recommendations with the ordinances and implementation tools that affect Burnett County.

Goal 2: Balance appropriate land use regulations and individual property rights with community interests and goals.

1.4 Comprehensive Plan Development Process and Public Participation

The Wisconsin Comprehensive Planning legislation specifies that the governing body for a unit of government must prepare and adopt written procedures to foster public participation in the comprehensive planning process. This includes open discussion, communication programs, information services, and public meetings for which advance notice has been provided, in every stage of the preparation of a comprehensive plan. Public participation includes wide distribution of proposed drafts, plan alternatives, and proposed amendments of the comprehensive plan. Public participation includes opportunities for members of the public to send written comments on the plan to the applicable governing body, and a process for the governing body to respond. The Town of Dewey has adopted a *Public Participation and Education Plan* in order to comply with the requirements of Section 66.1001(4) (a) of the Wisconsin Statutes. The town's adopted *Public Participation and Education Plan* is found in Appendix B.

The Burnett County comprehensive planning process was designed to encourage extensive grassroots, citizen-based input. Not only were public outreach tools and events utilized, but citizens were directly involved in writing their own local comprehensive plans, as well as the county comprehensive plan. Please refer to Sections 1.3 through 1.5 of the *Burnett County Inventory and Trends Report* for further details on the plan development and public participation processes.

In addition to the public participation process described in the *Burnett County Inventory and Trends Report*, the process of adopting the *Town of Dewey Year 2030 Comprehensive Plan* included several public participation activities. These include Dewey public informational meetings, Planning Committee, Plan Commission, and Town Board action, a public hearing, and the distribution of recommended and final plan documents.

Public Meetings

In accordance with the County planning process, Webb Lake used Plan Commission meetings, cluster meetings, and public informational meetings as part of the planning process. Webb Lake participated in six integrated cluster meetings at the county level, and held several local plan commission meetings as part plan development. Each participating community worked through a 'base package' process of meetings and local work sessions as facilitated by Foth and Burnett County. The cluster planning process provided the framework to enable each community to work through the planning process and hit key plan development benchmarks while allowing enough schedule flexibility to facilitate local, issue specific meetings.

The county also held periodic public informational meetings as part of the integrated meeting process to allow for efficient communication to the general public and ensure access to information as key points during plan development. Each public informational meeting included both county and local information and was attended by both local and county officials. Please refer to the Issues and Opportunities chapter of the Burnett County Inventory and Trends Report for more detail.

Plan Commission and Town Board Action

On [REDACTED], the Town of Dewey Plan Commission discussed the draft comprehensive plan and passed resolution number [REDACTED] recommending approval of the plan to the Town Board. After completion of the public hearing, the Town of Dewey Town Board discussed and adopted the comprehensive plan by passing ordinance number [REDACTED] on [REDACTED].

Public Hearing

On [REDACTED], a public hearing was held on the recommended *Town of Dewey Year 2030 Comprehensive Plan* at the town hall. The hearing was preceded by Class 1 notice and public comments were accepted for 30 days prior to the hearing. Verbal and written comments were taken into consideration by the Town Board before taking action to adopt the plan.

Distribution of Plan Documents

Both the recommended draft and final plan documents were provided to adjacent and overlapping units of government, the local library, and the Wisconsin Department of Administration in accordance with the *Public Participation and Education Plan* found in Appendix B.

1.5 Town of Dewey Issues and Opportunities

The initial direction for the comprehensive planning process was set by identifying community issues and opportunities. Issues were defined as challenges, conflicts, or problems that a community is currently facing or is likely to face in the future. Opportunities were defined as the positive aspects of a community that residents are proud of and value about their community. These could either be current positive aspects of a community, or have the potential to be created in the future.

In the first round of cluster meetings held December 15-16, 2008, the Town of Dewey Planning Commission Members and community representatives reviewed a base set of issues and opportunities developed by the County Planning Committee. These issues and opportunities were then revised by the participants to reflect the Town's unique conditions. After the full list was developed, each participant voted on the statements to establish a sense of priority. The following issues and opportunities were identified:

Table 1-1
Issues and Opportunities Identification
Town of Dewey

Issues Identified by the Town of Dewey	
Services	5
The need for government services is increasing while simultaneously, the traditional mechanisms which support those services are being cut. This is leading to increased workloads due to lack of resources (staff, time, funds, space, time to	

Issues Identified by the Town of Dewey

train, time to plan, reactive rather than proactive, competition for scarce resources, etc.). It is expected that this trend will continue for some time into the future. Strategies are needed to determine which services to eliminate, reduce, or leverage with technology (self service). Strategies are needed to increase efficiencies through cooperation with other units of governments and consolidation of services. Strategies are also needed to determine which service to grow or invest in.

Natural Resources

5

Preservation and enhancement to spur economic growth while maintaining Northwood's character. The perception is that access to public lands, Recreation, wildlife is being threatened. Furthermore, there is concern over loss of woods, "green spaces", and how sensitive areas such as lakes are becoming overdeveloped.

How to Pay for Them

4

Simultaneously, strategies are needed to tap into the County's strong property tax base, low business tax structure; ability to leverage grants to off-set local taxes and tap into state and federal programs, increase revenue from forest, room tax, highway, fees, develop new fee for services.

Issues Identified by the Town of Dewey

Economic Development that is Appropriate to the Town of Dewey 2

Leverage the potential strengths to spur economic growth and mitigate the weaknesses that hinder economic growth. The lack of retail stores, limited number of manufacturing jobs lack of markets for wood and contractors and the lack of trained professionals to run businesses needs to be leveraged against the ability to generate marketing dollars for expanded tourism, international tourism, and work more closely with the tribal enterprises. Strategies are needed.

Technology Issues 2

County has good technology infrastructure; leverage technology – wireless, DSL, fiber optics, internet (could be a sub-set of communication).

Lakefront Water Issues 1

Demand for lake front property and lake access has caused increased development pressure on lakes in the County. Many lakes are threatened with overcrowding and the problems associated with overuse such as public recreation conflicts, surface water use conflicts, adverse impacts to sensitive riparian, and littoral habitats. (Could be a sub-set of Natural Resource issues.)

Maintain the Town of Dewey's Northwoods Character/Quality of Life 1

The perception is this is currently being threatened by increasing development, population, tourism and poor development practices. The General character of the County is being affected by unsightly development and land use conflicts. A widespread perception that existing land use controls and guidance have not kept pace with the changing conditions. The issue needs to be defined and then develop strategies to protect that definition.

Skills Development 1

Address the lack of technical skills and ability to receive training to upgrade skills; strategy to tap into the skilled, educated secondary homeowners (this could be a sub-set of economic development)

Youth Issues 1

Brain drain, Creating opportunities for youth that will keep them in the Town of Dewey; lack of opportunities for youth (maybe causing brain-drain), lack of funding for schools, declining enrollments, lack of state funding, etc.

Demographic Shifts and its Impacts 1

Loss of youth increase of elderly. We are losing young people who need work, while simultaneously gaining older people who need services. Need a strategy to keep young people here, attract high tech individuals to area and tap into their skills.

Elderly Issues

Retirement and turnover (staff and Board), increasing demand for government services

Communication Improvements

It is perceived that overall communication needs to improve; poor communication between County and Tribe; inter-departmental, between state and county, with other agencies, the public, the unions, etc.

Issues Identified by the Town of Dewey

Transportation Issues

Infrastructure investment (highways and highway building), work in opposite direction by implementing local resources; no major highway or access to a major airport; location not on interstate highway system (rail access?).

Housing Issues

Affordability; scattered development.

1.6 Issues and Opportunities Policies and Recommendations

Policies and recommendations build on goals and objectives by providing more focused responses to the issues that the town is concerned about. Policies and recommendations become primary tools the town can use in making land use decisions. Many of the policies and recommendations cross element boundaries and work together toward overall implementation strategies. Refer to Section 9.5 for an explanation of the strategies cited as sources for many of the policies and recommendations.

Policies identify the way in which activities are conducted in order to fulfill the goals and objectives. Policies that direct action using the word “shall” are advised to be mandatory and regulatory aspects of the implementation of the comprehensive plan. In contrast, those policies that direct action using the words “will” or “should” are advisory and intended to serve as a guide. “Will” statements are considered to be strong guidelines, while “should” statements are considered loose guidelines.

2. Population and Housing

2.1 Population and Housing Plan

Population and housing are two key indicators that will help the Town of Dewey plan ahead for future growth and change. Because they are key indicators of potential future conditions, this element of the comprehensive plan provides a brief summary of population and housing data along with projections for the future. For further detail on population and housing in the Town of Dewey and Burnett County, please refer to Chapter 2 of the *Inventory and Trends Report*.

The Town of Dewey's plan for population and housing reflects its diverse landscape which includes aspects of both rural and shoreline-oriented population and housing characteristics. Regardless of which landscape applies, the town's primary concern is to retain rural character as population and housing growth continue into the future. Due to its rural nature, the town anticipates that single family, owner-occupied homes will continue to dominate the housing stock. However, as the aging segment of the population grows, it is expected that demand for elder care facilities, mixed use development, multi-family structures, and other forms of housing will increase. The relative accessibility of medical services and urban amenities coupled with the town's rural character and natural amenities will continue to make Dewey an attractive location for a variety of housing types.

The town's plan for population and housing is focused on protecting agriculture and forestry, preserving natural resources and rural character, and promoting housing affordability as housing growth takes place. Top issues and opportunities identified during the planning process (refer to *Issues and Opportunities* element) related to housing include potential conflicts between agriculture and rural housing development, the amount of land required to build a house, and the lack of affordable housing. Therefore, opportunities for future housing growth will be provided by protecting the town's best agricultural and forest lands from high density development while allowing more development to take place in other areas of the town. Preventing land use conflicts between intensive agriculture operations and housing development is a primary concern. These issues are addressed in detail by other elements of this plan, and key implementation tools include the management of development density, the use of conservation land division design, and the use of site planning guidelines.

2.2 Population Characteristics Summary

2000 Census

A significant amount of information, particularly with regard to population, housing, and economic development, was obtained from the U.S. Bureau of the Census. There are two methodologies for data collection employed by the Census, STF-1 (short form) and STF-3 (long form). STF-1 data were collected through a household by household census and represent responses from every household in the country. To get more detailed information, the U.S. Census Bureau also randomly distributes a long form questionnaire to one in six households throughout the nation. Tables that use these sample data are indicated as STF-3 data. It should

be noted that STF-1 and STF-3 data may differ for similar statistics, due to survey limitations, non-response, or other attributes unique to each form of data collection.

It should also be noted that some STF-3 based statistics represent estimates for a given population, and statistical estimation errors may be readily apparent in data for smaller populations. For example, the total number of housing units will be identical for both STF-1 statistics and STF-3 statistics when looking at the county as a whole – a larger population. However, the total number of housing units may be slightly different between STF-1 statistics and STF-3 statistics when looking at a single community within Burnett County – a smaller population.

Population Counts

Population counts provide information both for examining historic change and for anticipating future community trends. Figure 2-1 displays the population counts of the Town of Dewey for 1970 through 2008 according to the U.S. Census.

Figure 2-1
Population, Town of Dewey, 1970-2008

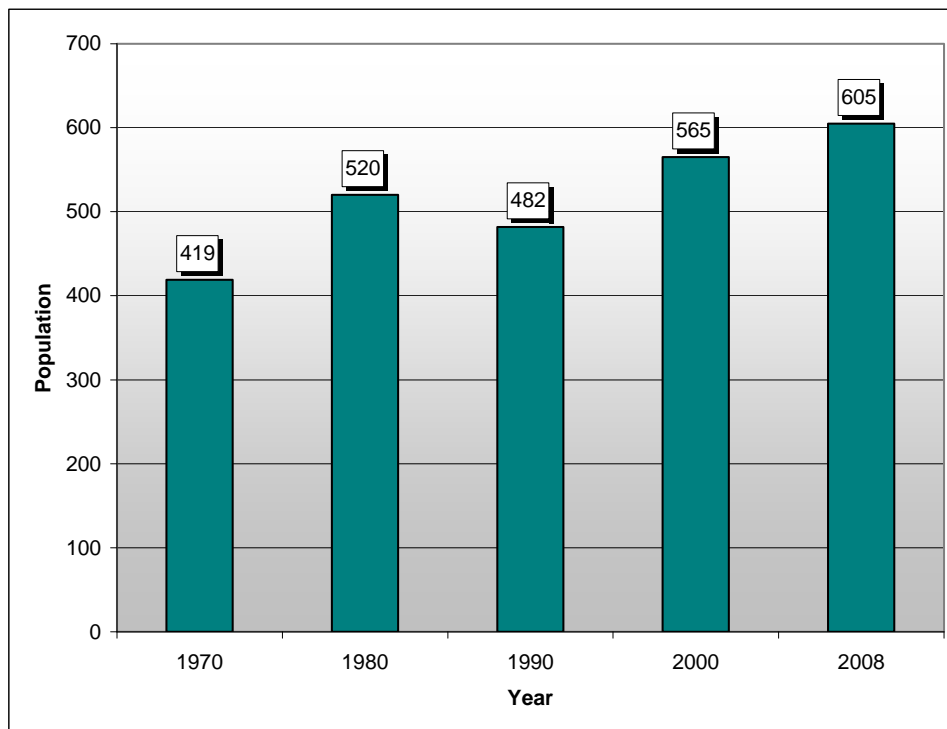

Source: U.S. Bureau of the Census, 1970-2000.

As displayed by Figure 2-1, the Town of Dewey has grown substantially over the 38 year period. Approximately 184 people were added to the population representing an increase of 44% from 1970 to 2008. Within the past eight years, the population in the Town of Dewey has increased by 7.1%, which is fairly average for other communities in the county. As of 2008, the town ranked in the lower half in terms of population when compared to all the other towns in Burnett County.

Table 2-1 displays the population trends of Burnett County, its municipalities, and the State of Wisconsin from 1970 to 2008 according to the U.S. Census.

Table 2-1
Population Counts, Burnett County, 1970-2008

	1970	1980	1990	2000	2008	% Change 1970 - 1980	% Change 1980 - 1990	% Change 1990 - 2000	% Change 2000-2008
T. Anderson	193	265	324	372	402	37.3%	22.3%	14.8%	8.1%
T. Blaine	129	151	172	224	229	17.1%	13.9%	30.2%	2.2%
T. Daniels	532	607	602	665	713	14.1%	-0.8%	10.5%	7.2%
T. Dewey	419	520	482	565	605	24.1%	-7.3%	17.2%	7.1%
T. Grantsburg	501	677	860	967	1,139	35.1%	27.0%	12.4%	17.8%
T. Jackson	128	331	457	765	860	158.6%	38.1%	67.4%	12.4%
T. La Follette	269	388	416	511	517	44.2%	7.2%	22.8%	1.2%
T. Lincoln	119	215	228	286	310	80.7%	6.0%	25.4%	8.4%
T. Meenon	596	838	956	1,172	1,257	40.6%	14.1%	22.6%	7.3%
T. Oakland	311	486	480	778	895	56.3%	-1.2%	62.1%	15.0%
T. Roosevelt	177	178	175	197	204	0.6%	-1.7%	12.6%	3.6%
T. Rusk	211	349	396	420	405	65.4%	13.5%	6.1%	-3.6%
T. Sand Lake	306	422	439	556	567	37.9%	4.0%	26.7%	2.0%
T. Scott	252	409	419	590	648	62.3%	2.4%	40.8%	9.8%
T. Siren	550	887	910	873	920	61.3%	2.6%	-4.1%	5.4%
T. Swiss	518	587	645	815	871	13.3%	9.9%	26.4%	6.9%
T. Trade Lake	673	824	831	871	970	22.4%	0.8%	4.8%	11.4%
T. Union	147	199	221	351	346	35.4%	11.1%	58.8%	-1.4%
T. Webb Lake	125	256	200	381	421	104.8%	-21.9%	90.5%	10.5%
T. West Marshland	173	209	293	331	388	20.8%	40.2%	13.0%	17.2%
T. Wood River	876	883	948	974	1,032	0.8%	7.4%	2.7%	6.0%
V. Grantsburg	930	1,153	1,144	1,369	1,460	24.0%	-0.8%	19.7%	6.6%
V. Siren	639	896	863	988	947	40.2%	-3.7%	14.5%	-4.1%
V. Webster	502	610	623	653	685	21.5%	2.1%	4.8%	4.9%
Burnett County	9,276	12,340	13,084	15,674	16,791	33.0%	6.0%	19.8%	7.1%
Wisconsin	4,417,731	4,705,642	4,891,769	5,363,675	5,648,124	6.5%	4.0%	9.5%	5.3%

Source: U.S. Bureau of the Census, 1970-2008

Population Forecasts

Population forecasts are based on past and current population trends. They are not predictions, but rather they extend past trends into the future, and their reliability depends on the continuation of these trends. Projections are therefore most accurate in periods of relative socio-economic and cultural stability. Projections should be considered as one of many tools used to help anticipate future needs in the Town of Dewey.

Two sources have been utilized to provide population projections. The first projection is from the Wisconsin Department of Administration (which is the official state projection through 2030). The second projection is a linear trend based on census data going back to 1970. Figure 2-2 displays the two population projections created for the Town of Dewey.

Figure 2-2
Comparative Population Forecast, 2008-2030
Town of Dewey Population Forecasts

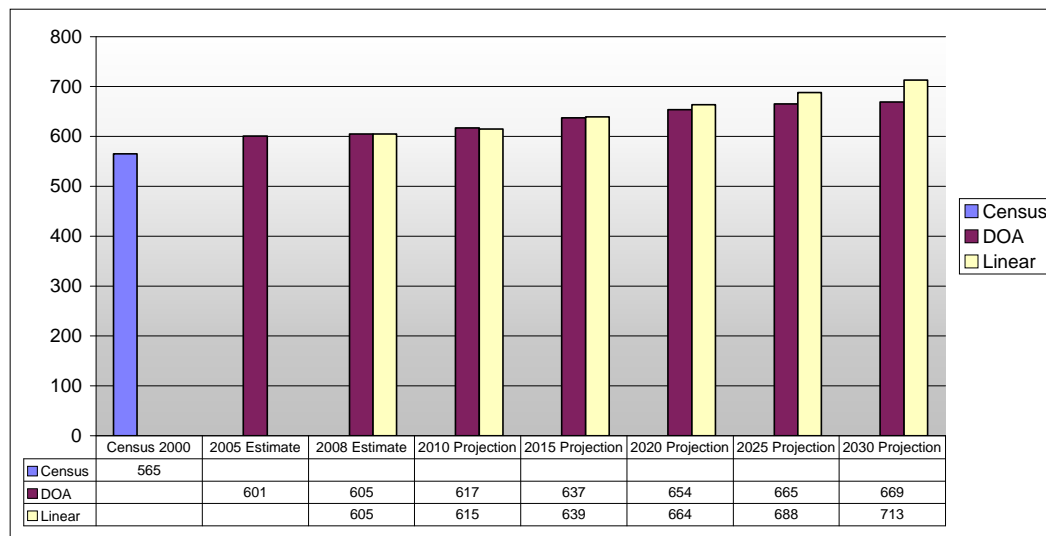

Source: Wisconsin Department of Administration, Demographic Services Center, Final Population Projections for Wisconsin Municipalities: 2000-2030, May 2008. Foth Infrastructure & Environment LLC linear projections 2005-2030.

The two available projections vary widely and forecast a range of population growth from 64 to 108 additional persons from 2008 to 2030. The actual growth scenario is likely to be somewhere in between the two projections. The rate of growth has slowed in recent years, and economic trends support continued slowing of local population growth. On the other hand, the features of the Town of Webb Lake that attract people to the area will continue to make this a growing part of Burnett County. For the purpose of forecasting future land use demand (refer to the *Land Use* element), the WDOA population projection and the linear projection were averaged. This

projection equates to 22% growth or an average of about 4 new people per year over the 30 year period.

2.3 Housing Characteristics Summary

Housing Supply, Occupancy, and Tenure

Tables 2-2 and 2-3 display the occupancy and tenure characteristics of housing units for Burnett County and the Town of Dewey in 1990 and 2000.

Table 2-2
Housing Supply, Occupancy, and Tenure, Town of Dewey,
1990 and 2000

	1990	Percent of Total	2000	Percent of Total	# Change 1990 - 2000	% Change 1990 - 2000
Total housing units	241	100.0%	303	100.0%	62	25.7%
Occupied housing units	156	64.7%	209	69.0%	53	34.0%
Owner-occupied	127	81.4%	181	86.6%	54	42.5%
Renter-occupied	29	18.6%	28	13.4%	-1	-3.4%
Vacant housing units	85	35.3%	94	31.0%	9	10.6%
Seasonal units	64	75.3%	88	93.6%	24	37.5%

Source: U.S. Bureau of the Census, STF-1, 1990-2000.

Table 2-3
Housing Supply, Occupancy, and Tenure, Burnett County,
1990 and 2000

	1990	Percent of Total	2000	Percent of Total	# Change 1990 - 2000	% Change 1990 - 2000
Total housing units	11,743	100.0%	12,582	100.0%	839	7.1%
Occupied housing units	5,242	44.6%	6,613	52.6%	1,371	26.2%
Owner-occupied	4,232	36.0%	5,587	44.4%	1,355	32.0%
Renter-occupied	1,010	8.6%	1,026	8.2%	16	1.6%
Vacant housing units	6,501	55.4%	5,969	47.4%	-532	-8.2%
Seasonal units	5,870	90.3%	5,664	94.9%	-206	-3.5%

Source: U.S. Bureau of the Census, STF-1, 1990-2000.

The housing supply in the Town of Dewey consists of a variety of housing types in terms of occupancy and tenure. While most of the housing supply consists of owner-occupied, year round homes, there are also significant numbers of renter-occupied and seasonal homes. Compared to Burnett County as a whole, there are smaller proportions of renter-occupied units and vacant year round units in the town. These data suggest that the housing supply in Dewey is slightly more difficult to access in terms of rental units and vacant unit availability and sales. The presence of seasonal units as a considerable piece of the housing supply is a reflection of the importance of tourism in the county.

Between 1990 and 2000, the town experienced trends similar to those of the county as a whole. Owner-occupied units grew at a faster rate in the town, and renter-occupied units grew at a similar rate. The Town of Dewey was impacted by the recent trend to convert many seasonal units to year round homes.

Housing Units in Structure

Figure 2-3 displays the breakdown of housing units by type of structure (“units in structure”) for the Town of Dewey on a percentage basis for 2000.

Figure 2-3
Units in Structure, Town of Dewey, 2000

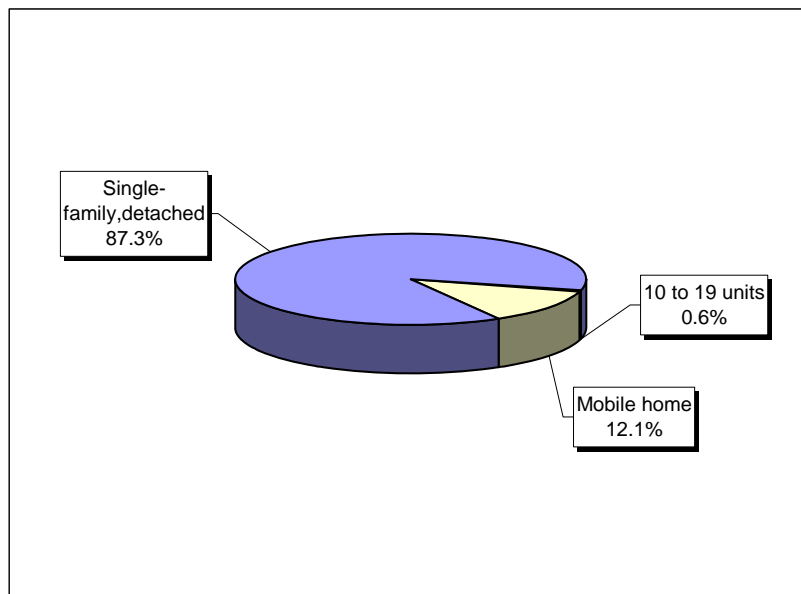

Source: U.S. Bureau of the Census, 2000, STF-3.

One-unit, detached structures dominate the housing supply at about 87%, and mobile home units make up a total 12.1%. These data show that the housing supply in the Town of Dewey is fairly homogenous; however, the variety of multiple unit homes also displays a fair amount of diversity for an unincorporated town.

Housing Unit Projections

Housing unit projections use historical data to extend past trends into the future. These projections serve as a guideline for land use decisions; however, their reliability depends on a variety of issues. Projections are more accurate in times of social and economic stability. A housing unit projection is just one of many tools that elected officials and staff should use to plan for the future development in the Town. Trends that may influence the future number for

housing units include demographic trends, including the declining household size and increasing age of residents, as well as other issues, such as the quality of the existing housing stock, the availability of municipal services, and the current trend of converting seasonal housing into permanent year-round housing.

Figure 2-4 shows Year 2030 housing projections that range from an increase of 34 housing units to an increase of 58 housing units from 2008 to 2030. The more conservative projection was based on WisDOA population projections, which take into account demographic and migration trends, while the higher projection was based on historical trends from the U.S. Census. The actual growth scenario is likely to be between these two projections. This equates to an average of between about 1 and 3 new homes per year over the 22 year period. The projected new housing unit growth is not an indication that all new structures will be constructed, as there could be housing units created from modifying existing single family residences etc. Within the last 10 years, the town has issued as many as 18 building permits per year for new construction. However, growth has slowed in recent years, and this trend is not expected to continue. The rate of future housing growth is likely to equate to about 46 new homes by 2030.

Figure 2-4
Comparative Housing Unit Projections
Town of Dewey, 2000-2030

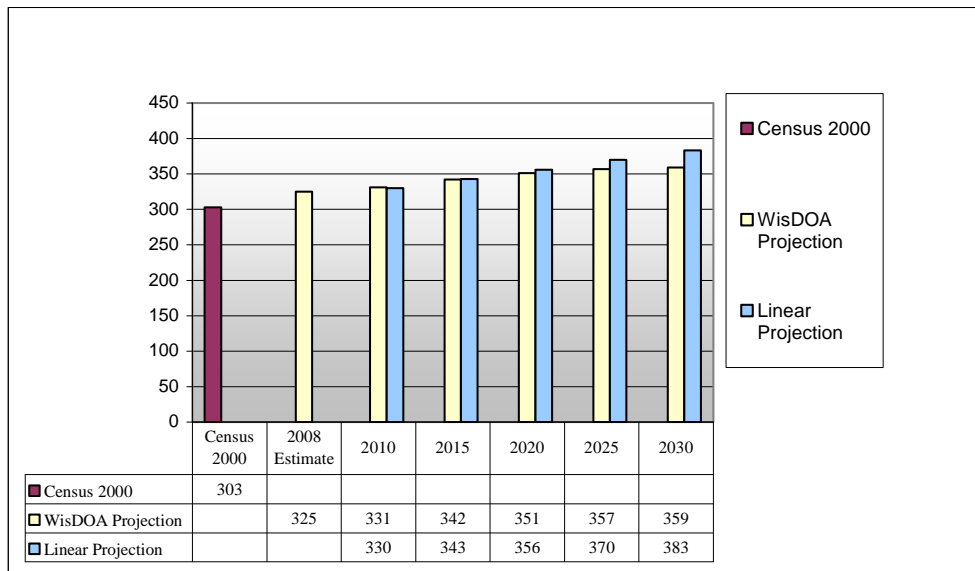

Source: U.S. Bureau of the Census, 2000, STF-1. Linear Trend Projection, 2005-2030. Burnett County Zoning Department, building permit data.

2.4 Population and Housing Trends and Outlook

Of the population and housing trends identified for Burnett County and the State of Wisconsin (refer to Section 2.4 of the *Inventory and Trends Report*), the following are likely to be experienced in the Town of Dewey over the next 20 to 25 years.

- ♦ The aging population is growing, and people over 65 are projected to comprise a significant portion of the total population by 2030.
- ♦ Minority populations are expected to increase.
- ♦ Expect the continued conversion of seasonal to permanent structures.
- ♦ Condominiums will increase as an option for seniors and first time home buyers.
- ♦ Interest in modular and mobile home development will continue as driven by need for affordable housing.
- ♦ People will continue to desire an “acre or two in the country,” and pressure to convert farmland, woodland and open areas to subdivisions and lots will increase, especially in rapidly growing areas.
- ♦ The need for elderly housing will increase as the population ages.
- ♦ Vacant housing units may increase as a result from the aging population choosing other options like assisted living, condominiums, and the like.
- ♦ Finding quality, affordable housing will become increasingly difficult.
- ♦ High demand for housing and energy cost assistance will continue.

2.5 Housing for All Income Levels

The housing stock in rural Wisconsin communities typically has a high proportion of single-family homes, with few other housing types available. While a range of housing costs can be found in single-family homes, larger communities are generally relied upon to provide a greater variety of housing types and a larger range of costs. It is a benefit to a community to have a housing stock that matches the ability of residents to afford the associated costs. This is the fundamental issue when determining housing affordability and the ability to provide a variety of housing types for various income levels.

The Department of Housing and Urban Development (HUD) defines housing affordability by comparing income levels to housing costs. According to HUD, housing is affordable when it costs no more than 30% of total household income. For renters, HUD defined housing costs include utilities paid by the tenant.

According to the U.S. Census, housing in the Town of Dewey appears to be affordable on the average. The median household income in the town in 1999 was \$28,917 per year, or \$2,410 per month. The median monthly owner cost for a mortgaged housing unit in the town was \$725, and the median monthly gross rent in the town was \$360. The term “gross rent” includes the average estimated monthly cost of utilities paid by the renter. According to the HUD definition of affordable housing, the average home owner in the Town of Dewey spends about 30% of household income on housing costs, and therefore has affordable housing. The average renter in the Town of Dewey spends about 15% of household income on housing costs, and therefore has affordable housing. It should be noted, however, that this does not rule out individual cases where households do not have affordable housing. In fact, in 1999, 37.1% of homeowners and 31.6% of renters in the Town of Dewey paid 30% or more of their household income on housing costs.

2.6 Housing for All Age Groups and Persons with Special Needs

As the general population ages, affordability, security, accessibility, proximity to services, transportation, and medical facilities will all become increasingly important. Regardless of age, many of these issues are also important to those with disabilities or other special needs. As new residents move into the area and the population ages, other types of housing must be considered to meet all resident needs. This is particularly true in communities where a large proportion of the population includes long-time residents with a desire to remain in the area during their retirement years.

The Wisconsin Department of Administration has projected that a significant shift in Burnett County’s age structure will take place by 2035. More than 7,100 Burnett County residents are expected to be age 65 and older by that time, growing from 21% of the 2005 estimated population to 38% of the projected 2030 population. As this shift in the age structure takes place, communities may find it necessary to further assess the availability of housing for all age groups and persons with special needs.

2.7 Promoting Availability of Land for Development/Redevelopment of Low-Income and Moderate-Income Housing

Promoting the availability of underdeveloped or underused land is one way to meet the needs of low- and moderate-income individuals. One way to accomplish this is to plan for an adequate supply of land that will be zoned for housing at higher densities or for multi-family housing. Another option is to adopt housing policies requiring that a proportion of units in new housing developments or lots in new subdivisions meet a standard for affordability. Two elements of comprehensive planning are important in this equation. In the Housing element, a community can set its goals, objectives, and policies for affordable housing. In the Land Use element, a community can identify potential development and redevelopment areas.

[Need to insert information about opportunities for affordable housing in future land use plan]

2.8 Maintaining and Rehabilitating the Existing Housing Stock

The maintenance and rehabilitation of the existing housing stock within the community is one of the most effective ways to ensure safe and generally affordable housing without sacrificing land to new development. To manage housing stock maintenance and rehabilitation, a community can monitor characteristics including, price, aesthetics, safety, cleanliness, and overall suitability with community character. The goal of ongoing monitoring is to preserve the quality of the current housing supply with the hope of reducing the need for new development, which has far greater impacts on community resources.

2.9 Population and Housing Goals and Objectives

Community goals are broad, value-based statements expressing public preferences for the long term (20 years or more). They specifically address key issues, opportunities, and problems that affect the community. Objectives are more specific than goals and are more measurable statements usually attainable through direct action and implementation of plan recommendations. The accomplishment of objectives contributes to fulfillment of the goal.

Goal 1: To guide new housing development into areas that can be efficiently served in a fashion that does not impact scarce natural resources.

Objectives:

- A. Support opportunities for multi-family, group housing, and other high-density residential development within existing neighborhoods with established sewer and water services.
- B. Direct residential development to planned growth areas.

Goal 3: Support housing development that maintains the attractiveness and rural character of the county.

Objectives:

- A. Direct the development of large residential subdivisions to planned growth areas in order to prevent conflicts between residential development and productive land uses like agriculture and forestry.
- B. Require the development of low to moderate-income housing to be consistent in quality, character, and location with the goals, objectives, and policies of applicable comprehensive plans.
- C. Encourage the use of creative development designs that preserve rural character, agricultural lands, productive forests, and natural resources.

2.10 Population and Housing Policies and Recommendations

Policies and recommendations build on goals and objectives by providing more focused responses to the issues that the town is concerned about. Policies and recommendations become primary tools the town can use in making land use decisions. Many of the policies and recommendations cross element boundaries and work together toward overall implementation strategies. Refer to Section 9.5 for an explanation of the strategies cited as sources for many of the policies and recommendations.

Policies identify the way in which activities are conducted in order to fulfill the goals and objectives. Policies that direct action using the word “shall” are advised to be mandatory and regulatory aspects of the implementation of the comprehensive plan. In contrast, those policies that direct action using the words “will” or “should” are advisory and intended to serve as a guide. “Will” statements are considered to be strong guidelines, while “should” statements are considered loose guidelines.

Recommendations are specific actions or projects that the town should be prepared to complete. The completion of these actions and projects is consistent with the town’s policies, and therefore will help the town fulfill the comprehensive plan goals and objectives.

Policies and Recommendations

1. Siting and construction of new housing shall be consistent with the purpose, intent, and preferred density established in the applicable Land Use Management Areas and meet the applicable review criteria established by other planning element policies.
2. The county should consider allowing for flexible site design (e.g., lot size) and allow clustering of building sites to help lower land costs, preserve farmland, and reduce woodland fragmentation provided proposals are consistent with other provisions of the comprehensive plan.
3. Manufactured dwellings should feature designs similar to “stick-built” homes.
4. Establish development standards for housing other than single family housing.
5. Cluster residential development will be promoted to minimize land use impacts while accommodating development and greenspace.
 - a. Houses should be clustered as to minimize the visual and environmental impacts to the rural landscape.
6. Any multi-family residential development that abuts established low-density residential areas should be very carefully designed to minimize potential negative impacts on existing homes.
7. Housing within rural areas should be placed on the landscape in a fashion that reduces the impacts to natural vegetation, preserves quality farmland, reduces farmland fragmentation and does not block potential road extensions.

8. Housing ordinances, policies, standards and ideals shall be made available to new homeowners to ensure their knowledge of local housing regulations.

2.11 Population and Housing Programs

For descriptions of housing programs potentially available to the community, refer to the *Population and Housing* element of the *Burnett County Inventory and Trends Report*.

3. Transportation

3.1 Transportation Plan

The land use patterns of the Town of Dewey, Burnett County, and the surrounding region are tied together by the transportation system, including roadways and trails. Households, businesses, farms, industries, schools, government, and many others all rely on a dependable transportation system to function and to provide linkages to areas beyond their immediate locations. The Town of Dewey's transportation network plays a major role in the efficiency, safety, and overall desirability of the area as a place to live and work. For further detail on transportation in the Town of Dewey and Burnett County, please refer to Chapter 3 of the *Inventory and Trends Report*.

With the amount of population and housing growth that is expected over the next 20 years, the Town of Dewey should also anticipate change to its transportation system. The town's plan for transportation is to be prepared for potential development proposals, to ensure that future expansion of the town's road system is cost-effective, to preserve the mobility and connectivity of local roads, to improve opportunities for pedestrian and bicycle routes, and to ensure that developed properties have safe emergency vehicle access. In order to achieve this, the town should consider adopting a driveway ordinance, coordinate with the county to review all land divisions for access and layout considerations, plan for road improvements, and continue to maintain a set of town road construction specifications. The policies and recommendations of this plan provide guidance on how these tools should be used.

As the town implements its plan, a key dilemma will be balancing the rural character and mobility of existing roads with the maximum use of existing road infrastructure. On one hand, existing roads are already present, new roads are costly, and new development can be more cost effective if it utilizes existing roads. On the other hand, extensive placement of new development in highly visible locations along existing roads will forever change the character and appearance of the town. This may lead to a loss of rural character. Adding access points to serve new development also reduces the mobility of a road. This plan includes a policy that directs new development to utilize the existing road network to the maximum extent possible (policy LU___). However, this plan also encourages new subdivisions to utilize conservation design which will usually require the construction of new roads, but does a better job of preserving rural character.

In order to balance these competing interests, the town will require the coordinated planning of adjacent development sites by limiting the use of cul-de-sacs and by requiring the use of Area Development Plans. In order to balance these competing interests, the town will require the coordinated planning of adjacent development sites by limiting the use of cul-de-sacs and by reviewing Area Development Plans. Over the long term, the town may also develop an official map to preserve planned rights-of-way and connections between developed areas. The town should require that potential traffic and road damage impacts are assessed by developers as part of the development application.

3.2 Planned Transportation Improvements

It is a recommendation of this plan that a five-year road improvement plan be annually updated in the future. Future road improvement plans should attempt to provide integration with the plan for preferred land use. Areas planned for higher density residential growth should receive priority for improvements in order to support such growth. Road improvements that are necessary in areas where agriculture, forestry, and outdoor recreational are planned as primary uses should be accompanied by zoning regulations, access controls, and other growth management tools.

3.3 Comparison with County, State, and Regional Transportation Plans

State, regional, and county transportation plans have been reviewed for their applicability to the Town of Dewey. _____ highway improvement projects and recommendations by the Northwest Wisconsin Regional Planning Commission regarding _____ apply to the town. No planned state transportation improvement projects directly impact the town.

The Town of Dewey has the following recommendations with regard to the current functional classification of highways in the town. Several roads currently classified as local roads should be considered as potential collectors due to increased traffic, growth and development, and connections provided between other major routes or important destinations.

◆ ...

3.4 Transportation Goals and Objectives

Community goals are broad, value-based statements expressing public preferences for the long term (20 years or more). They specifically address key issues, opportunities, and problems that affect the community. Objectives are more specific than goals and are more measurable statements usually attainable through direct action and implementation of plan recommendations. The accomplishment of objectives contributes to fulfillment of the goal.

Goal 1: Provide for a Safe, Efficient, and Environmentally Sound Transportation System which, through its location, capacity, and design, will effectively serve the existing land use development pattern and meet anticipated transportation demand generated by existing and planned land uses.

Objectives:

- A. Protect historic, scenic, scientific, and cultural sites when constructing new or improving existing transportation facilities.
- B. Minimize the disruption of environmentally sensitive areas when constructing new or improving existing transportation facilities.

- C. Design transportation facilities to be aesthetically pleasing and sensitive to the landscape, including such amenities as buffers in urban areas and minimizing unsightly views such as junkyards, billboards, and strip commercial development in rural areas.
- D. Manage right-of-way vegetation to protect wildlife, appropriate use of herbicides, reduce maintenance costs, and improve safety.
- E. Locate transportation facilities to minimize exposure of people to harmful or annoying air, water, or noise pollution levels.
- F. Reduce accident exposure by improving deficient roadways.
- G. Manage driveway access location and design to ensure traffic safety, provide adequate emergency vehicle access, and prevent damage to roadways and ditches.
- H. Require developers to bear the costs for the improvement or construction of roads needed to serve new development.
- I. Guide new growth to existing road systems so that new development does not financially burden the county or make inefficient use of tax dollars.
- J. Monitor the effectiveness of existing, and opportunities for new, shared service agreements for providing county and local road maintenance.

Goal 2: To support the efforts of villages and towns within the County to provide safe and efficient multi-modal transportation systems where appropriate.

Objectives:

- A. Encourage local units of government to maintain and implement their respective roadway improvement plans.
- B. Support alternative transportation such as bicycling and walking as viable, convenient, and safe transportation choices in the county through a greater number of routes and connections to other transportation systems and destinations.
- C. Improve accommodations on pedestrian facilities for people with disabilities (i.e., curb cuts, minimizing inclines and slopes of sidewalks, ensuring sidewalk connectivity, and increasing signal times at crossings, etc.).
- D. Encourage the monitoring of transit needs, particularly for senior residents.

Goal 3: Promote cooperation and coordination between state, county, towns, and villages in developing the County transportation system.

Objectives:

- A. Encourage communication between communities regarding transportation projects that cross municipal boundaries.
- B. Promote an inter-county transportation system consisting of trails, roads, and highways.
- C. Encourage local communities to actively participate in transportation planning at the regional level with Northwest Wisconsin Regional Planning Commission, the Wisconsin Department of Transportation, and Burnett County Highway Department.
- D. Communicate with community groups on transportation systems to assist communities in prioritization and funding of projects.
- E. Support and encourage the utilization of rail systems.
- F. Support and encourage the utilization of air transportation.

- G. Maintain and implement the County's roadway improvement plan.
- H. Maintain and upgrade air transportation facilities in accordance with the airport facility plan.
- I. Direct future residential, commercial, and industrial development to roadways capable of accommodating resulting traffic.
- J. Direct truck traffic to appropriate routes and plan cooperatively with affected communities.

3.5 Transportation Policies and Recommendations

Policies and recommendations build on goals and objectives by providing more focused responses to the issues that the town is concerned about. Policies and recommendations become primary tools the town can use in making land use decisions. Many of the policies and recommendations cross element boundaries and work together toward overall implementation strategies. Refer to Section 9.5 for an explanation of the strategies cited as sources for many of the policies and recommendations.

Policies identify the way in which activities are conducted in order to fulfill the goals and objectives. Policies that direct action using the word "shall" are advised to be mandatory and regulatory aspects of the implementation of the comprehensive plan. In contrast, those policies that direct action using the words "will" or "should" are advisory and intended to serve as a guide. "Will" statements are considered to be strong guidelines, while "should" statements are considered loose guidelines.

Recommendations are specific actions or projects that the town should be prepared to complete. The completion of these actions and projects is consistent with the town's policies, and therefore will help the town fulfill the comprehensive plan goals and objectives.

Policies and Recommendations

1. A five-year road improvement plan shall be maintained and annually updated to identify and prioritize road improvement projects as well as identify potential funding sources.
2. The town shall consider bicycle and pedestrian safety needs when new roads are proposed or when roadway improvements are made.*(Consider bike trails independent of the road system- if not addressed elsewhere)
3. Actively pursue available funding, especially federal and state sources, for needed transportation facilities. Funding for multimodal facilities should be emphasized where appropriate.
4. Modify the county land division ordinance to support local requirements for the execution of a development agreement when ever public roads or other infrastructure is included in a development. Create a model development agreement for adaptation by interested towns.

5. Update and maintain the town highway access control (driveway) ordinance to implement access control and emergency vehicle access standards.
6. Continue to bi-annually update a detailed capital improvement plan that includes transportation, public facility, and other capital needs. The plan should prioritize short-term and long-term needs, include equipment needs, identify potential funding sources, and discuss contingency plans in the event that funds are not available.
7. The PASER (Pavement Service and Evaluation Rating System) shall be utilized to annually update the 5-year Road improvement Program, including funding sources and priorities for identified improvement projects.
8. Developers shall bear an equitable share of the costs for improvements and extensions to the transportation network.
9. Street design standards (intersection design, signal phasing, and roadway width) shall give priority to and enhance the safety of pedestrians and minimize conflict with motorists. Priority for installation or construction should be given to those routes that are used by school children, senior citizens, physically challenged persons and/or commuters.
10. The existing road network and public facilities and services will be utilized to accommodate new development to the maximum extent possible.
11. Whenever feasible, promote the separation of truck and through-traffic from local traffic and reroute truck traffic around the community as much as possible.
12. Proper ditch location, grading practices and shape will be pursued to ensure runoff is adequately given an outlet.
13. Evaluate the need for a public transportation system and evaluate the need for a separate the need for a separate bike system.
14. As part of the review of major subdivisions or conditional uses for commercial or industrial uses, The County should consider requiring developers to provide an Area Development Plan that assess the potential for connecting planned subdivision roads with future development on surrounding properties.
15. Create a set of model town road construction specifications to include modern requirements for road base, surfacing, and drainage construction as well as options for pedestrian and bicycle features. Construction specifications should be adjustable based on the planned functional classification or expected traffic flow of a roadway. (check with Morehouse)
16. Create a model town road access control (driveway) ordinance to assist towns with implementing access control and emergency vehicle access standards. (check with Morehouse)

17. Train local communities in the use of current and efficient road assessment systems to maintain local road improvement plans.
18. Residential development proposals will be designed to include an efficient system of internal circulation for all vehicles and pedestrians including the provision for external collector streets, and trails where applicable, to feed all traffic onto external arterial roads and highways.
19. Roads that provide access to multiple improved properties shall be built to community standards as a condition of approval for new development.
20. Ensure that the transportation needs of the physically challenged are met.
21. Encourage communities to consider opportunities to create or improve bicycle and pedestrian transportation options in concert with the review of proposed developments and planning for road improvements or public facilities.
22. Work with Burnett County towns to develop a consistent approach for the posting of seasonal and permanent weight limits, especially with respect to the conduct of agricultural and forestry operations.
 - a. Where road weight limits are posted, access to agricultural and forest lands should be allowed for the conduct of all normal and necessary farming and forestry operations. This can be achieved through the use of Class B weight limits or through the issuance of exemption permits. Note: No vehicle is automatically exempt from posted weight limits. Exemptions only occur through the issuance of exemption permits or through the use of Class B weight limits.
23. Transportation related issues which have effects in neighboring areas should be jointly discussed and evaluated with that neighbor and the Wisconsin Department of Transportation if necessary.
24. The county, villages and towns shall cooperatively prepare a transportation system plan for the area designating corridors for major facilities (arterials, collectors, transit corridors, etc.)
25. The county should lead an initiative to establish design guidelines for the visual quality of major community thoroughfares by requiring all development and redevelopment along these entry corridors to include site plan and design review.

3.6 Transportation Programs

For descriptions of transportation programs potentially available to the community, refer to the *Transportation* element of the *Burnett County Inventory and Trends Report*. The additional programs shown here are of high importance to the Town of Dewey and should be monitored for their applicability to local transportation issues and opportunities.

Additional Programs

Local Roads Improvement Program

Established in 1991, the Local Roads Improvement Program (LRIP) assists local governments in improving seriously deteriorating county highways, town roads, and Village and village streets. A reimbursement program, LRIP pays up to 50% of total eligible costs with local governments providing the balance. In order to be eligible for LRIP funds, a unit of government must have a current road improvement plan.

Local Bridge Improvement Assistance Program

The Local Bridge Improvement Assistance program helps rehabilitate and replace, on a cost-shared basis, the most seriously deficient existing local bridges on Wisconsin's local highway systems. Counties, villages, villages, and towns are eligible for rehabilitation funding on bridges with sufficiency ratings less than 80, and replacement funding on bridges with sufficiency ratings less than 50.

Pavement Surface Evaluation and Rating (PASER)

PASER is a simple method of rating asphalt and concrete roads on a scale of 1 to 10 and gravel roads on a scale of 1 to 5, based on visual inspection. PASER manuals and a video explain how and why roads deteriorate, and describe proper repair and replacement techniques. PASER rating can be put into PASERWARE, an easy to use pavement management software package. PASERWARE helps to inventory roads and keep track of their PASER ratings and maintenance histories. It also helps to prioritize road maintenance and improvement needs, calculate project costs, evaluate the consequences of alternative budgets and project selection strategies, and communicate those consequences to the public and local officials. Both PASER and PASERWARE are available from the University of Wisconsin's Transportation Information Center at no charge. The Center also offers free training courses. Call (800) 442-4615 for more information.

4. Utilities and Community Facilities

4.1 Utilities and Community Facilities Plan

Efficient provision of high quality community facilities and services impacts property values, taxes, and economic opportunities, and contributes to the quality of life in the Town of Dewey. Local features such as parks, schools, utilities, and protective services help define a community. These facilities and services require substantial investment as supported by the local tax base, user fees, and impact fees. As a result, their availability is determined both by public demand for those facilities and services, and by a community's ability to pay for them. Therefore, potential impacts on the cost and quality of utilities and community facilities need to be considered when making decisions concerning the future conservation and development of the Town of Dewey.

For further detail on existing utilities and community facilities in the Town of Dewey and Burnett County, please refer to Chapter 4 of the *Inventory and Trends Report*. Map 4-11 displays the locations of existing community facilities and services found in the town.

With the amount of population and housing growth that is expected over the next 20 years, the Town of Dewey should also anticipate the need to maintain and expand utilities, community facilities, and services. Top issues and opportunities identified during the planning process (refer to the *Issues and Opportunities* element) include the cost of community service and facility improvements and the related tax impacts, the need for additional law enforcement, and the need for improved facilities at public boat landings. The town's vision statement (also refer to the *Issues and Opportunities* element) contemplates the need for improved town administration and professional services. Overall, the town's plan for utilities and community facilities is to monitor changing needs, to be prepared for proposed development, and to make planned improvements as growth warrants the need.

[Need to insert section about town administrative issues]

[Need to insert section about physical improvements to utilities and community facilities]

One of the biggest challenges that the town is likely to face with regard to utilities and community facilities is the impact of growth on the cost of providing such services. Research by UW-Extension, the American Farmland Trust, and others has shown that not all new development pays for itself. In other words, the cost of the increased demand on public services and facilities resulting from new development often exceeds the revenue generated in new taxes and fees paid. This seems to be true of residential development in particular. As a result, this plan recommends that substantial new developments provide an analysis of the cost of providing community services as part of the development review process. It also recommends that impact fees are considered as a potential tool for funding needed facility and service improvements.

The actual pattern of growth on the landscape can also impact the cost and efficiency of delivering services. In general, dispersed development is more costly to service than clustered or concentrated development. This plan recommends that the town carefully manage growth in order to minimize the demand for increased services and facilities and encourages the use of

cluster or conservation design in order to avoid a dispersed development pattern.

Map 4-1 Community Facilities and Services

This page intentionally left blank.

4.2 Planned Utility and Community Facility Improvements

Comprehensive planning includes identifying the need for expansion, construction, or rehabilitation of utilities and community facilities. In addition to infrastructure needs, there are also service level needs that may arise in the community. For example, additional police service, need for a building inspector, or additional park and recreation services may become necessary.

The Town of Dewey has determined that the following utilities, facilities, and services will need expansion, construction, rehabilitation, or other improvement over the planning period. Projects are identified as short-term (1-5 years) and long-term (6-20 years), and if associated with a specific location in the community, are shown on Map 4-50.

Administrative Facilities and Services

Refer to Section 4.2 of *Appendix UCF* of the *Inventory and Trends Report* for information on existing administrative facilities and services in the Town of Dewey.

Short Term

◆ ...

Long Term

◆ ...

Police Services

Refer to Section 4.3 of *Appendix UCF* of the *Inventory and Trends Report* for information on existing police services in the Town of Dewey.

Short Term

◆ ...

Long Term

◆ ...

Fire Protection and EMT/Rescue Services

Refer to Section 4.3 of the *Inventory and Trends Report* for information on existing fire and emergency medical/rescue services.

Short Term

◆ ...

Long Term

◆ ...

Schools

Refer to Section 4.4 of the *Inventory and Trends Report* for information on the schools that serve the Town of Dewey. No short term or long term recommendations have been identified. Existing schools are anticipated to be adequate to meet the needs of the town over the planning period.

Libraries, Cemeteries, and Other Quasi-Public Facilities

Refer to Section 4.5 of the *Inventory and Trends Report* for information on existing libraries, post offices, and private recreational facilities in Burnett County. Refer to Section 4.5 of *Appendix UCF* of the *Inventory and Trends Report* for information on churches and cemeteries in the Town of Dewey.

Short Term

♦ ...

Long Term

♦ ...

Parks and Recreation

Refer to Section 4.6 of *Appendix UCF* of the *Inventory and Trends Report* for information on existing park and recreational facilities in the Town of Dewey.

Short Term

♦ ...

Long Term

♦ ...

Solid Waste and Recycling

Refer to Section 4.7 of *Appendix UCF* of the *Inventory and Trends Report* for information on existing solid waste and recycling service in the Town of Dewey.

Short Term

♦ ...

Communication and Power Facilities

Refer to Section 4.8 of the *Inventory and Trends Report* for information on the communication and power facilities that serve the Town of Dewey. No short term or long term recommendations have been identified. Existing communication and power facilities are anticipated to be adequate to meet the needs of the town over the planning period.

Sanitary Sewer Service

Refer to Section 4.9 of the *Inventory and Trends Report* for information on sanitary sewer service in Burnett County.

Short Term

◆ ...

Long Term

◆ ...

Private On-Site Wastewater Treatment Systems (POWTS)

Refer to Section 4.10 of the *Inventory and Trends Report* for information on private on-site wastewater treatment systems (POWTS) in Burnett County.

Short Term

◆ ...

Long Term

◆ ...

Public Water

Refer to Section 4.11 of the *Inventory and Trends Report* for information on public water supply in Burnett County.

Short Term

◆ ...

Long Term

◆ ...

Stormwater Management

Refer to Section 4.12 of the *Inventory and Trends Report* for information on stormwater management in the Town of Dewey.

Short Term

◆ ...

Long Term

◆ ...

Health Care and Child Care Facilities

Refer to Sections 4.14 and 4.15 of the *Inventory and Trends Report* for information on health care and child care facilities in Burnett County. No short term or long term recommendations have been identified. Existing health care and child care facilities are anticipated to be adequate to meet the needs of the town over the planning period.

Local Roads and Bridges

Refer to the *Transportation* element of this plan and the *Transportation* element of the *Inventory and Trends Report* for information on roads and bridges in Burnett County.

Short Term

♦ ...

Long Term

♦ ...

Map 4-2 Planned Community Facility and Transportation Improvements

This page intentionally left blank.

4.3 Utilities and Community Facilities Goals and Objectives

Community goals are broad, value-based statements expressing public preferences for the long term (20 years or more). They specifically address key issues, opportunities, and problems that affect the community. Objectives are more specific than goals and are more measurable statements usually attainable through direct action and implementation of plan recommendations. The accomplishment of objectives contributes to fulfillment of the goal.

Goal 1: Support the efficiency, quality, and coordinated planning of county government, community facilities and services, and utilities.

Objectives:

- A. Improve the efficiency of both county service delivery, and county facilities operation, while striving to meet public expectations with respect to both service levels and costs.
- B. Consider the impacts of development proposals on the cost and quality of county and community facilities and services.
- C. Guide intensive development to areas where appropriate utilities, community facilities, and public services are available.
- D. Determine the need for new, expanded, or rehabilitated services and county government facilities.
- E. Maintain an adequate level of properly trained county staff and volunteers.
- F. Explore opportunities to provide or improve county facilities, equipment, and services cooperatively with other units of government.
- G. Encourage increased coordination between community facilities and utilities planning and planning for other elements such as land use, transportation, natural resources, and cultural resources.

Goal 2: Provide quality and accessible parks and recreational facilities.

Objectives:

- A. Monitor the adequacy of park and recreational facilities, and identify areas where improvements are needed.
- B. Seek improved accessibility for all age groups and abilities at appropriate county park and recreational facilities.
- C. Pursue state, federal, and private funding programs that can aid in the acquisition and development of parks, trails, and scenic or environmentally sensitive areas.
- D. Maximize the quality of life by providing regional open space, trails, parks and recreational opportunities and facilities managed in such a fashion as to afford the maximum benefit to the community.
- E. Consider the continued viability of outdoor recreational pursuits when reviewing development proposals and making land use decisions.
- F. Maintain existing, and seek additional public access to waterways.

- G. Support efforts to acquire additional public recreational lands and create additional public recreational trails when they are consistent with county and local comprehensive plans.

4.4 Utilities and Community Facilities Policies and Recommendations

Policies and recommendations build on goals and objectives by providing more focused responses to the issues that the town is concerned about. Policies and recommendations become primary tools the town can use in making land use decisions. Many of the policies and recommendations cross element boundaries and work together toward overall implementation strategies. Refer to Section 9.5 for an explanation of the strategies cited as sources for many of the policies and recommendations.

Policies identify the way in which activities are conducted in order to fulfill the goals and objectives. Policies that direct action using the word “shall” are advised to be mandatory and regulatory aspects of the implementation of the comprehensive plan. In contrast, those policies that direct action using the words “will” or “should” are advisory and intended to serve as a guide. “Will” statements are considered to be strong guidelines, while “should” statements are considered loose guidelines.

Recommendations are specific actions or projects that the town should be prepared to complete. The completion of these actions and projects is consistent with the town’s policies, and therefore will help the town fulfill the comprehensive plan goals and objectives.

Policies and Recommendations

1. Capital expenditures for the major expansion or rehabilitation of existing facilities or services shall be supported by an approved Capital Improvement Plan. Capital expenditures for the establishment of new facilities or services shall be handled on a case-by-case basis.
2. Continue to annually update a detailed capital improvement plan that includes transportation, public facility, and other capital needs. The plan should prioritize short-term and long-term needs, include equipment needs, identify potential funding sources, and discuss contingency plans in the event that funds are not available.
3. The town shall maintain adequate staffing and professional service levels relative to planning, ordinance development and enforcement, and other governmental services to successfully implement the comprehensive plan.
4. The town shall maintain adequate administrative facility and public building space.
5. Substantial development proposals shall provide an assessment of potential impacts to the cost of providing town facilities and services. The depth of analysis required by the county will be appropriate for the intensity of the proposed development.

6. The creation of an Adequate Public Facilities Requirement will be considered within the county. In order to ensure that property is developed only with appropriate urban or rural services, no development shall be approved unless the approving authority first determines that adequate facilities and services will be available to the development before it is occupied.
7. A proportional share of the cost of improvement, extension and construction of public facilities should be borne by those whose land development and redevelopment actions made such improvement, extension and construction necessary. In determining the proportional share, the public benefit of the project/improvement shall be considered. Impact fees should be utilized as a source of funding for capital projects directly attributable to new development. Impact fee programs shall be considered for transportation facilities, schools, parks, and fire protection.
8. Whenever possible, use public/private agreements to pay for utility extensions into new subdivisions.
9. The county shall encourage the shared development of all public capital facilities including community facilities such as parks, libraries, schools and community meeting facilities.
10. The county shall consider intergovernmental and other cooperative options before establishing, expanding, or rehabilitating community facilities, utilities, or services.
11. All town buildings shall meet ADA requirements and have adequate capacity to facilitate community meetings or gatherings.
12. Maintain an up to date county Comprehensive Outdoor Recreation Plan and integrate it with the comprehensive plan to ensure consistency.
13. The county shall support efforts that are consistent with the comprehensive plan to expand public recreational resources such as parks, trails, waterway access, public hunting and fishing areas, wildlife viewing areas, and the like.
14. Determine which lands in the county would enhance the county park and open space system based on local comprehensive plans.
15. New development and planned utilities, service facilities, and roads should be designed to limit the potential negative impacts to recreational resources such as public lands, wildlife habitat, surface water, interconnected green space corridors, wetlands, woodlands and other existing vegetation, public access, hunting opportunities, existing and proposed trails, and motorized recreational vehicle (ATV, snowmobile, etc.) use opportunities.
16. All park facilities shall be in compliance with the Americans with Disabilities Act.

4.5 Utilities and Community Facilities Programs

For descriptions of utilities and community facilities programs potentially available to the community, refer to the *Utilities and Community Facilities* element of the *Burnett County Inventory and Trends Report*.

5. Agricultural, Natural, and Cultural Resources

5.1 Agricultural, Natural, and Cultural Resources Plan

Land development patterns are directly linked to the agricultural, natural, and cultural resource base of a community. This resource base has limitations with respect to the potential impacts of development activities. Development should be carefully adjusted to coincide with the ability of the agricultural, natural, and cultural resource base to support the various forms of urban and rural development. If a balance is not maintained, the underlying resource base may deteriorate in quality. Therefore, these features need to be considered when making decisions concerning the future conservation and development of the Town of Dewey. For further detail on agricultural, natural, and cultural resources in the Town of Dewey and Burnett County, please refer to Chapter 5 of the *Inventory and Trends Report*.

The *Agricultural, Natural, and Cultural Resources* element may be the most important element in the *Town of Dewey Year 2030 Comprehensive Plan*. Many of the issues and opportunities identified by the town during the planning process (refer to the *Issues and Opportunities* element) are related to these resources. The town is concerned with preserving surface water and groundwater quality, preserving woodlands and wildlife, protecting rural character and scenic views, limiting noise and light pollution, preserving agricultural lands, preventing conflicts between agriculture and rural housing development, preventing conflicts over mineral resources, and preserving historic and archeological sites. Some of the strongest points of consensus on the public opinion surveys were related to these resources and include: protecting groundwater, wetlands, and waterways; protecting forests and wildlife habitat; protecting farmland and productive soils; supporting the agriculture industry; protecting rural character; and protecting historical sites and structures.

Agricultural Resources

Agriculture is a significant component of the Town of Dewey's landscape, and the town's extensive irrigated agriculture operations are connected to a larger region of irrigated vegetable farming that spans several counties. The town's plan for agricultural resources is to preserve agricultural lands and the right to farm while also allowing for planned development. Higher density residential development is planned on lands that are less suitable for agricultural use. Lower density development would be allowed on lands critical to the town's agricultural base. Key components and considerations of the town's approach include establishing a maximum lot size in certain areas, limiting major subdivisions to planned growth areas, encouraging conservation land division design, establishing site planning guidelines, and potentially revising the zoning map that applies to the town. The town also plans to explore the creation of a purchase of development rights (PDR) or purchase of conservation easement (PACE) program in cooperation with Burnett County.

Substantial agricultural resources are present in the Town of Dewey. According to the 2007 Land Use Assessment data, there were approximately 9,509 acres of farmland in the town. The town of Dewey has the highest amount of agricultural land in the county. In other words, over 40% of the land is used for agricultural purposes. Nearly 10,900 acres of land in the Town of Dewey is considered prime agricultural or prime when drained, or farmland of statewide significance, which is also the highest total of prime farmland for a town in Burnett County.

Agriculture lands are significant in the Town of Dewey, and these lands are expected to continue in agricultural use over the long term. This sentiment is reflected in the preferred future land use plan (refer to the *Land Use* element) as most of the town's agricultural lands have been mapped for Agricultural Enterprise (AE). The AE Preferred Future Land Use Management Area seeks to preserve and promote a full range of agricultural uses and prevent the conversion of land to uses not consistent with agriculture.

Irrigated cropland brings with it unique land management and planning implications. Irrigated lands represent substantial infrastructure investments that turn otherwise unproductive land into reliable areas for vegetable production. Because such a substantial investment has been made to create these productive lands, it is unlikely that they will be converted to other non-agricultural uses during the planning period. Unlike many other types of farmland, the market value of irrigated land is as much as, if not more than, the value of the land for development.

Natural and Cultural Resources

The Town of Dewey's plan for natural and cultural resources is to help ensure that existing regulations are followed in the town and to manage growth to prevent negative impacts to these resources. Natural and cultural resources are abundant in the town and are highly valued by the town's residents. Preserving rural character, forest resources, and outdoor recreational opportunities are primary concerns as reflected in the town's goals and objectives, its issues and opportunities, and the results of the planning process surveys. Substantial natural and cultural resources are present in the town and include the following:

- ♦ 1,616 acres of wetlands
- ♦ 2,259 acres of floodplains
- ♦ 557 acres of lakes

Many of the same tools that will be used to protect agriculture could also be used to protect natural and cultural resources, including a maximum residential lot size, conservation land division design, site planning guidelines, the zoning map, and a possible transfer or purchase of development rights program. In addition the town may require substantial development proposals assess potential natural and cultural resources impacts. Other tools recommended for cultural resources include maintaining the inventory of historic and archeological sites and creating a historic preservation ordinance.

5.2 Agricultural, Natural, and Cultural Resources Goals and Objectives

Community goals are broad, value-based statements expressing public preferences for the long term (20 years or more). They specifically address key issues, opportunities, and problems that affect the community. Objectives are more specific than goals and are more measurable statements usually attainable through direct action and implementation of plan recommendations. The accomplishment of objectives contributes to fulfillment of the goal.

Agricultural Resources

Goal 1: Maintain the viability, operational efficiency, and productivity of the county's agricultural resources for current and future generations.

Objectives:

- A. Protect through local and state measures the County's productive lands from accelerated erosion and unwise development.
- B. Protect productive farmland from fragmentation and conflicts with non-agricultural uses.
- C. Allow for farming expansion in areas where conflict with existing residential land uses can be prevented or mitigated.
- D. Protect the investments made, in both public infrastructure (roads) and private lands and improvements, that support the agricultural industry.
- E. Encourage creative, unique and niche forms of agriculture.
- F. Promote opportunities to allow farmers and farmland owners to secure financial benefits for the preservation of agricultural lands.
- G. Encourage the use of agricultural science-based Best Management Practices to minimize erosion and groundwater and surface water contamination.
- H. Support programs that provide mentoring of younger farmers.
- I. Increase awareness relative to the importance of protecting the viability of the county's agricultural industry.
- J. Increase awareness and understanding of farming operations, noises, odors and use of roadways by farm vehicles and equipment.

Goal 2: Balance the protection of farmland with the exercise of development rights.

Objectives:

- A. Identify lands where the primary intent is to preserve productive farmland and to allow for farming expansion.
- B. Identify lands where the primary intent is to allow for rural residential development.
- C. Encourage adequate buffers between agricultural uses and residential neighborhoods to minimize potential conflicts.

- D. Consider establishing site design requirements and standards that direct low density rural residential development to areas that minimize conflicts between residential and agricultural land uses and maintain the rural character of the county.

Natural Resources

Goal 3: Encourage the efficient management of the County's natural resources.

Objectives:

- A. Maintain and implement a 15-year forest plan consistent with accepted standards.
- B. Maintain and implement a county wide recreation plan.
- C. Maintain the County's farmland preservation plan.
- D. Promote sound forest management practices on private forest lands.
- E. Protect the public's access to public hunting and fishing areas.
- F. Assess the County's wild rice resources in conjunction with the St. Croix Tribe of Chippewa Indians and establish a link to protection through shoreline development regulation.
- G. Develop management strategies to create a sustainable relationship between recreational vehicles, watercraft, and natural resources.
- H. Encourage communication between communities regarding the protection of natural resources that cross municipal boundaries.
- I. Provide educational programs that support resource protection and management goals.
- J. Educate resource users of the County's environmental quality goals and objectives.

Goal 4: Balance future development with the protection of natural resources.

Objectives:

- A. Consider the potential impacts of development proposals on groundwater quality and quantity, surface water quality, open space, wildlife habitat, woodlands, and impact of light intrusion on the night sky.
- B. Direct future growth away from regulatory wetlands and floodplains.
- C. Promote public and private efforts to protect critical habitats for plant and animal life.
- D. Promote the utilization of public and non-profit resource conservation and protection programs such as Managed Forest Law (MFL), Conservation Reserve Program (CRP), and conservation easements.
- E. Promote renewable energy conservation within new and existing developments.

Goal 5: Protect air quality.

Objectives:

- A. Regulate outdoor burning and ban the burning of garbage in barrels or other methods.
- B. Manage growth to minimize conflict between residences and agricultural odors and dust.

Goal 6: Preserve and protect woodlands and forest resources for their economic, aesthetic, and environmental values.

Objectives:

- A. Conserve large contiguous wooded tracts in order to reduce forest fragmentation, maximize woodland interiors, and reduce the edge/area ratio.
- B. Consider the use of conservation land division design, which reduces further forest fragmentation.
- C. Support efforts that preserve the integrity of managed forest lands.
Encourage forestry practices that encourage woodland buffers during woodland harvest.
Provide educational resources on forestry practices and the benefits to a healthy forest.

Goal 7: Balance future needs for the extraction of mineral resources with potential adverse impacts on Burnett County.

Objectives:

- A. Encourage the registration of known economically viable non-metallic mineral deposits.
- B. Require the consistent regulation of non-metallic mineral extraction operations to minimize adverse impacts on adjacent land uses and to ensure proper site reclamation.
- C. Consider the potential adverse impacts of proposed metallic mineral extraction operations, and ensure that the siting of such facilities will not negatively impact Burnett County's natural resources.

Cultural Resources

Goal 8: Preserve the Northwoods character as defined by scenic beauty, a variety of landscapes, undeveloped lands, forests, water resources, wildlife, farms, rural and small town atmosphere, buildings integrated with the landscape, and enjoyment of these surroundings.

Objectives:

- A. Consider the potential impacts of development proposals on those features that communities value
- B. Eliminate the accumulation of junk vehicles, poorly maintained properties, unsightly advertising, and roadside litter.
- C. Support the efforts of Burnett County's villages to preserve a small town atmosphere including attractive community entrances, small businesses, a vital downtown, and community culture and events.
- D. Enforce the zoning code.
- E. Encourage the growth and development of visual, performance, and cultural arts.

Goal 9: Strengthen opportunities for youth in Burnett County including youth-oriented activities and facilities and additional job opportunities.

Objectives:

- A. Involve youth in the comprehensive planning process.
- B. Establish the involvement of youth in county decision making.
- C. Support youth development programs.

5.3 Agricultural, Natural, and Cultural Resources Policies and Recommendations

Policies and recommendations build on goals and objectives by providing more focused responses to the issues that the town is concerned about. Policies and recommendations become primary tools the town can use in making land use decisions. Many of the policies and recommendations cross element boundaries and work together toward overall implementation strategies. Refer to Section 9.5 for an explanation of the strategies cited as sources for many of the policies and recommendations.

Policies identify the way in which activities are conducted in order to fulfill the goals and objectives. Policies that direct action using the word “shall” are advised to be mandatory and regulatory aspects of the implementation of the comprehensive plan. In contrast, those policies that direct action using the words “will” or “should” are advisory and intended to serve as a guide. “Will” statements are considered to be strong guidelines, while “should” statements are considered loose guidelines.

Recommendations are specific actions or projects that the town should be prepared to complete. The completion of these actions and projects is consistent with the town’s policies, and therefore will help the town fulfill the comprehensive plan goals and objectives.

Policies and Recommendations

1. New development should be directed to the least productive soils to conserve remaining land for continued agricultural uses, whenever possible.
2. Improve the menu of agricultural zoning districts and update the zoning map where applicable in cooperation with towns in order to recognize preferred areas for agricultural expansion and to preserve the best agricultural lands for agricultural use.
3. Work with towns to develop a county-wide right to farm policy and ordinance. Create options for towns that wish to require right to farm language to be shown on recorded land divisions.
4. Work with local units of the government and the agriculture industry to implement the zoning provisions and performance standards of Wisconsin Act 235 and ACTP 51 (the Livestock Facility Siting Law).

5. Create and maintain an up to date inventory of active farms (including number of animal units per farm), feedlots, and manure storage facilities. This will be necessary for implementation of Wisconsin Act 235.
6. Maintain and/or create an inventory of livestock, feedlots and manure storage facilities. Monitor their location, abandonment, design and construction to evaluate their impacts.
7. New non-farm residential development in areas not served by central water/sewer systems shall be directed away from existing agricultural operations on large tracts of undeveloped land and directed toward those areas that have existing non-farm development.
8. New non-farm residential development shall only be allowed in areas not served by central water/sewer if such development is subject to a “nuisance disclaimer”, stringent deed restrictions or other mutual agreement intended to protect the “right-to-farm” of existing and future agricultural operations.
9. The existing farmland preservation plan will be evaluated for its effectiveness every 5 years and updates or amendments will be made as necessary.
10. Conservation and cluster land division design shall be supported as options for proposed major land divisions to minimize the negative impacts to agriculture, active farms, natural resources, cultural resources, and rural character while accommodating residential development.
11. Create a county easement donation program or purchase of development rights program.
12. New development should be directed to the least productive farmland areas to the fullest extent practicable and where consistent with other goals, objectives and policies of the comprehensive plan.
13. The expansion or establishment of agricultural operations resulting in 500 or more animal units shall be preferred no closer than 2,640 feet (1/2 mile) of sewer service areas or incorporated areas.
14. Consistent with Wisconsin Act 235, the establishment of new or expansion of existing animal agriculture operations that result in farms with more than 500 animal units shall comply with performance standards for setbacks, odor management, waste and nutrient management, waste storage facilities, runoff management, and mortality management.

Natural Resource Recommendations

15. Wisconsin Department of Natural Resources Best Management Practices and USDA Natural Resource Conservation Service standards and specifications shall be utilized to the maximum extent possible for activities approved in forests, shorelands, and wetlands.

16. Substantial (define) development proposals should provide the county with an analysis of the potential natural resources impacts including, but not necessarily limited to, potential impacts to groundwater quality and quantity, surface water, wetlands, floodplains, and woodlands. The depth of analysis required by the county will be appropriate for the intensity of the proposed development.
 17. Federal, state and county regulation changes or additions regarding agricultural, natural and cultural resources will be consistently monitored for their impact on local resources.
 18. Environmental corridors shall be defined by location of WDNR designated wetlands and FEMA designated floodplains.
 19. Environmental corridors shall be used for natural habitat, conservancy, trails and pathways, and outdoor recreation activities (e.g., hunting, hiking) which do not adversely impact natural features and open spaces found within the corridor.
 20. Conservation and cluster land division design shall be supported as options for proposed major land divisions to minimize the negative impacts to agriculture, active farms, natural resources, cultural resources, and rural character while accommodating residential development.
 21. New development should be placed on the landscape in a fashion that minimizes potential negative impacts to natural resources such as shoreline areas, wetlands, and floodplains.
 22. Establish an erosion control ordinance. *Check with Dave Ferris
 23. The clean-up and reuse of brown field sites should be pursued prior to utilized undeveloped land.
 24. Streets shall be designed and located in such manner as to maintain and preserve natural topography, cover, significant landmarks, and trees, and to preserve views and vistas.
 25. All forms of structural development or concentrated animal numbers will be restricted on the 100-year floodplains based on FEMA maps.
 26. During the building permitting process all permit holders will be informed if the site location is near or within a floodplain.
 27. Improve the menu of forestry zoning districts and update the zoning map in cooperation with towns in order to recognize preferred areas for forestry enterprise and to preserve the best forest lands for productive use.
 28. Incentives for private landowners to enroll woodlands in the various land and resource protection programs such as Managed Forest Law, Conservation Reserve Program, etc will be explored.
 29. Landowners in designated forestry areas will be encouraged to have a forestry management plan in place prior to development.
-

30. Trail development in forested areas will be required to have a long-term development plan in order to decrease misplacement of trails or inadequate location that do not consider future conditions.

Cultural Resource Recommendations

31. Conservation and cluster land division design shall be supported as options for proposed major land divisions to minimize the negative impacts to agriculture, active farms, natural resources, cultural resources, and rural character while accommodating residential development.
32. Substantial development proposals should provide the county with an analysis of the potential cultural resources impacts including, but not necessarily limited to, potential impacts to historic sites, archeological sites, and other cultural resources. The depth of analysis required by the county will be appropriate for the intensity of the proposed development.
33. New development should be placed on the landscape in a fashion that minimizes potential negative impacts to Northwoods character as defined by locally significant landmarks, scenic views and vistas, rolling terrain, undeveloped lands, farmlands and woodlands, aesthetically pleasing landscapes and buildings, limited light pollution, and quiet enjoyment of these surroundings.

5.4 Agriculture, Natural, and Cultural Resources Programs

For descriptions of agricultural, natural and cultural resources programs potentially available to the community, refer to the *Agricultural, Natural and Cultural Resources* element of the *Burnett County Inventory and Trends Report*.

6. Economic Development

6.1 Economic Development Plan

Economic development planning is the process by which a community organizes, analyzes, plans, and then applies its energies to the tasks of improving the economic well-being and quality of life for those in the community. Issues and opportunities in the Town of Dewey related to economic development mainly includes supporting regional economic development efforts in Burnett County Villages and in areas that have the necessary infrastructure to support intensive commercial development, and supporting tourism, agriculture, forestry, home-based business. All of these issues affect residents of the Town of Dewey and are addressed directly or indirectly in the comprehensive plan.

The reason to plan for economic development is straight-forward - economic development provides income for individuals, households, farms, businesses, and units of government. It requires working together to maintain a strong economy by creating and retaining desirable jobs which provide a good standard of living for individuals. Increased personal income and wealth increases the tax base, so a community can provide the level of services residents expect. A balanced, healthy economy is essential for community well-being. Well planned economic development expenditures are a community investment. They leverage new growth and redevelopment to improve the area. Influencing and investing in the process of economic development allows community members to determine future direction and guide appropriate types of development according to their values.

Successful plans for economic development acknowledge the importance of:

- ◆ Knowing the region's economic function in the global economy.
- ◆ Creating a skilled and educated workforce.
- ◆ Investing in an infrastructure for innovation.
- ◆ Creating a great quality of life.
- ◆ Fostering an innovative business climate.
- ◆ Increased use of technology and cooperation to increase government efficiency.
- ◆ Taking regional governance and collaboration seriously.

The Town of Dewey's plan for economic development is to maintain the quality of life that attracts residents, visitors, and businesses to the area, to support wireless and hard-line broadband service infrastructure to the area to promote tele-commuting and home-based business development. Dewey does not have intensive areas planned for commercial uses by design; the plan is to retain existing businesses and have a mixed use area that focuses on local service delivery and uses. Dewey does not envision significant local administration to function and deliver services to residents and property owners, and is not positioning for regional community competitiveness related to attracting new business. Dewey has established commercial and industrial development policies as necessary, but the long term economic development focus is related to encouraging sustainable residential development, supporting tourism, agriculture, forestry, home-based business, and improving overall quality of life. In the event that new local commercial or industrial uses are found to be consistent with the plan, it will be important to

address the site design and development characteristics to ensure compatibility with surrounding development and preservation of the areas rural character. The Town of Dewey exhibits some unique economic characteristics. The town's rural land base also plays an important economic role by supporting tourism and outdoor recreation, and by providing opportunities for quality, affordable housing.

Many of the top issues and opportunities identified during the planning process (refer to the *Issues and Opportunities* element) center around natural resources, lakefront and water related development, costs and delivery of services, and management of rural character. The rural character and low population concentration of the town does not support typical economic development strategy in the sense of new commercial buildings or a business park, but rather one focused on capitalizing on existing strengths such as waterfront development, home-based business, and natural resource management. The town is concerned with the amount and design of commercial development, the potential for light and noise pollution, and the negative economic and environmental impacts that might accompany such development, recruiting and retaining businesses that contribute to the tax base, and the potential for expanded employment in the services sector. In order to address these issues and opportunities and to implement the town's plan for economic development, this plan includes recommendations to develop a site and architectural design review ordinance. Commercial and industrial development will be required to meet certain standards for building and site design as guided by the town's economic development policies. The plan also recommends supporting the enhancement of relationships between educational institutions and potential employers.

6.2 Economic Characteristics Summary

This section provides detail on educational attainment and employment in the Town of Dewey. For further information on economic development in the Town of Dewey and Burnett County, please refer to Chapter 6 of the *Inventory and Trends Report*.

Educational Attainment

Table 6-1 displays the educational attainment level of Burnett County and Town of Dewey residents who were age 25 and older in 2000. The educational attainment level of persons within a community can provide insight into household income, job availability, and the economic well being of the community. Lower educational attainment levels in a community can be a hindrance to attracting certain types of businesses, typically those that require highly specialized technical skills and upper management positions.

Table 6-1
Educational Attainment of Persons Age 25 and Over, Burnett County
and Town of Dewey, 2000

Attainment Level	Town of Dewey		Burnett County	
	Number	Percent of Total	Number	Percent of Total
Less than 9th grade	17	4.6%	687	6.1%
9th grade to 12th grade, no diploma	55	15.0%	1,257	11.2%
High school graduate (includes equivalency)	179	48.9%	4,811	42.7%
Some college, no degree	38	10.4%	2,296	20.4%
Associate degree	39	10.7%	645	5.7%
Bachelor's degree	34	9.3%	1,131	10.0%
Graduate or professional degree	4	1.1%	446	4.0%
Total Persons 25 and over	366	100.0%	11,273	100.0%

Source: U.S. Bureau of the Census, STF-3, 2000.

Educational attainment for the Town of Dewey as measured in 2000 was fairly similar to that of the county. In each case, slightly less than half of the adult population is a high school graduate and approximately 10% of the population has a bachelor's degree. These data suggest that residents of the Town of Dewey are equipped to participate in all levels of the local and regional workforce, but also that the town can improve its position in the marketplace if more people were to reach a high school graduate level of attainment.

Employment by Industry

The employment by industry within an area illustrates the structure of the economy. Historically, the State of Wisconsin has had a high concentration of employment in manufacturing and agricultural sectors of the economy. More recent state and national trends indicate a decreasing concentration of employment in the manufacturing sector while employment within the services sector is increasing. This trend can be partly attributed to the aging of the population and increases in technology.

Table 6-2 displays the number and percent of employed persons by industry group in the Town of Dewey, Burnett County, and the State of Wisconsin for 2000.

Table 6-2
Employment by Industry, Town of Dewey, Burnett County, and
Wisconsin, 2000

Industry	Town of Dewey		Burnett County	
	Number	Percent of Total	Number	Percent of Total
Agriculture, forestry, fishing and hunting, and mining	40	16.6%	300	4.4%
Construction	15	6.2%	610	8.8%
Manufacturing	37	15.4%	1,446	21.0%
Wholesale trade	0	0.0%	143	2.1%
Retail trade	20	8.3%	807	11.7%
Transportation and warehousing, and utilities	11	4.6%	281	4.1%
Information	4	1.7%	112	1.6%
Finance, insurance, real estate and rental and leasing	11	4.6%	235	3.4%
Professional, scientific, management, administrative, and waste management services	3	1.2%	244	3.5%
Educational, health and social services	29	12.0%	1,271	18.4%
Arts, entertainment, recreation, accommodation and food services	28	11.6%	778	11.3%
Other services (except public administration)	12	5.0%	309	4.5%
Public administration	31	12.9%	357	5.2%
Total	241	100.0%	6,893	100.0%

Source: U.S. Bureau of the Census, STF-3, 2000.

Of the 241 Town of Dewey residents employed in 2000, most worked in the agriculture, manufacturing, or public administration sectors. The breakdown of employment by industry sector in the town is very similar to that of Burnett County as a whole, with some key distinctions. Notably larger proportions of town employment are found in the agriculture sector and a lower proportion of the employment is found in education, health, and social services.

Employment by Occupation

The previous section, employment by industry, described employment by the type of business or industry, or sector of commerce. What people do, or what their occupation is within those sectors provides additional insight into the local and county economy. This information is displayed in Table 6-3.

Table 6-3
Employment by Occupation, Town of Dewey, Burnett County, and
Wisconsin, 2000

Occupation	Town of Dewey		Burnett County		State of Wisconsin	
	Number	Percent of Total	Number	Percent of Total	Number	Percent of Total
Management, professional, and related occupations	59	24.5%	1,762	25.6%	857,205	31.3%
Service occupations	45	18.7%	1,234	17.9%	383,619	14.0%
Sales and office occupations	45	18.7%	1,407	20.4%	690,360	25.2%
Farming, fishing, and forestry occupations	18	7.5%	125	1.8%	25,725	0.9%
Construction, extraction, and maintenance occupations	31	12.9%	850	12.3%	237,086	8.7%
occupations	43	17.8%	1,515	22.0%	540,930	19.8%
Total	241	100.0%	6,893	100.0%	2,734,925	100.0%

Source: U.S. Bureau of the Census, STF-3, 2000.

Employment by occupation in the Town of Dewey is somewhat different from that of Burnett County. Compared to the county as a whole, there are notably larger proportions employed in farming, fishing, and forestry occupations, as well as in construction. These are offset by notably smaller proportions in management and professional services. These differences are logical given the local characteristics in educational attainment and employment by industry.

6.3 Desired Business and Industry

Similar to most communities in Burnett County, the Town of Dewey would welcome most economic opportunities that do not sacrifice community character or require a disproportionate level of community services per taxes gained. In this context, “business” could include any type of commercial use from a home-based business to a retail store, office, or other similar use. The categories or particular types of new businesses and industries that are desired by the community are generally described in the goals, objectives, and policies within this document. Desired types of business and industry in Burnett County include, but are not necessarily limited to:

- ♦ Business and light industry that retain the rural character of the community.
- ♦ Business and light industry that utilize high quality and attractive building and landscape design.
- ♦ Business and light industry that utilize well planned site design and traffic circulation.
- ♦ Business and light industry that revitalize and redevelops blighted areas of the town.
- ♦ Businesses that provide essential services that are otherwise not available in the surrounding neighborhood, such as retail stores, personal services, and professional services.
- ♦ Home based businesses that blend in with residential land use and do not harm the surrounding neighborhood.
- ♦ Business and light industry that provide quality employment for local citizens.
- ♦ Business and light industry that support existing employers with value adding services or processes.
- ♦ Business and light industry that bring new cash flow into the community.

- ♦ Business and light industry that fill a unique niche in the town and complement economic development efforts in the Village of _____.
- ♦ Business and light industry that capitalize on community strengths.
- ♦ Business and light industry that do not exacerbate community weaknesses.

6.4 Sites for Business and Industrial Development

Sites for business and industrial development are detailed on the future land use map (Map 8-2) for the Town of Oakland. Generally speaking, the Town of Dewey is not planning for significant areas of commercial and/or industrial development. The primary economic development opportunities will be through the expansion of home based businesses in the town's residential and rural areas, including some limited waterfront-oriented businesses where appropriate. The expansion and access of wireless broadband internet technology will be a significant driver to stimulation the expansion or opportunity of home based business development. Such uses will be required to meet the applicable *Land Use* element policies, and policies of other relative element included in this plan. Other areas of the town might also be considered for more intensive business development upon approval of a plan amendment or rezoning as appropriate. The Town of Dewey is pro economic growth and opportunity, as generally described in the Town's Goals, Objectives, Policies, and Recommendations; however, the majority of business development within the County is encouraged to take place within the Villages of Grantsburg, Siren, and Webster where adequate utilities and infrastructure exist or are planned for expansion.

While there are no industrial parks in the Town of Dewey, there are three industrial and business parks located in Burnett County, the Grantsburg Industrial Park, the Webster Industrial Park and the Siren Industrial Park. The industrial and business parks in Burnett County occupy a total of 120 acres, of which 68 acres are currently occupied. Therefore, 52 acres, or 43% of the County's existing industrial and business park lands are available for future development.

Environmentally Contaminated Sites

Brownfields, or environmentally contaminated sites, may also be good candidates for clean-up and reuse for business or industrial development. The WDNR's Bureau of Remediation and Redevelopment Tracking System (BRRTS) has been reviewed for contaminated sites that may be candidates for redevelopment in the community. For the Town of Dewey, as of May 2009, there were no sites identified by BRRTS as being located within the town and as being open or conditionally closed (indicating that further remediation may be necessary).

6.5 Economic Development Goals and Objectives

Community goals are broad, value-based statements expressing public preferences for the long term (20 years or more). They specifically address key issues, opportunities, and problems that affect the community. Objectives are more specific than goals and are more measurable statements usually attainable through direct action and implementation of plan recommendations. The accomplishment of objectives contributes to fulfillment of the goal.

Goal 1: Maintain and enhance opportunities for resource based industries dependent on rural lands and provide opportunity for compatible economic growth and development

Objectives:

- A. Encourage resource based industries including agriculture, forestry, and tourism which are consistent with the goals of this plan.
- B. Protect agricultural lands by enforcement of agricultural zoning districts.
- C. Establish the value of existing and potential agricultural land and help preserve them through the development of an agricultural “Transfer of Development Rights” (TDR) and/or “Purchase of Development Rights” (PDR) program managed by the County. These shall be supported by a priority system, a revenue mechanism, and an information/education program.
- D. Discourage any type of development, not agriculturally related, on prime agricultural soils identified in the TDR/PDR program.
- E. Encourage continuation of the family farm.
- F. Encourage creative, unique and niche forms of agriculture.
- G. Support programs that coordinate the selling of local products within local establishments.
- H. Support programs that provide opportunities for farmers to network to increase the potential to share knowledge, resources, and equipment.

Goal 2: Help provide sufficient commercial and industrial lands adjacent to public facilities and transportation services that are cost effective and environmentally compatible.

Objectives:

- A. Encourage appropriate re-use and development of older buildings.
- B. Designate sites for industrial and commercial use that will be accessible from roadways of arterial class or higher, potentially served with utilities, and free of major environmental constraints.
- C. In cooperation with local jurisdictions, maintain an adequate supply of industrial and commercial lands with a suitable mix of light and heavy industry, retail service and institutional use within designated growth areas in proximity to transportation services.
- D. Encourage infrastructure development and services necessary to serve new development.

Goal 3: Maintain the utility, communication, and transportation infrastructure systems that promote economic development.

Objectives:

- A. Work to maintain an effective and efficient government to reduce the tax burden.
- B. Improve economic development opportunities along highway corridors.
- C. Support the development of regional facilities, cultural amenities, and services that will strengthen the long-term attractiveness of the local communities, Burnett County, and the region.

- D. Monitor the infrastructure needs of established businesses in order to meet their expansion and facility needs when they are consistent with the county's comprehensive plan.
- E. Attract and support the development of world class communication systems.

Goal 4: Maintain a quality workforce to strengthen existing businesses and maintain a high standard of living.

Objectives:

- A. Support local employment of area citizens, especially efforts that create opportunities for local young adults.
- B. Support home-based businesses that do not significantly increase noise, traffic, odors, lighting, or would otherwise negatively impact the area.
- C. Support area school districts, technical colleges, universities, and other non-profit agencies that promote workforce development.
- D. Provide a continuum of educational opportunities responsive to the needs of the County work place.
- E. Encourage greater interaction between the county schools and businesses in order to better coordinate the required education and skills.
- F. Promote and encourage community development that creates and enhances vibrant neighborhoods, and shopping, entertainment and recreational opportunities that will attract and retain younger families and employers.
- G. Support intergovernmental efforts to development a local technical school.

6.6 Economic Development Policies and Recommendations

Policies and recommendations build on goals and objectives by providing more focused responses to the issues that the town is concerned about. Policies and recommendations become primary tools the town can use in making land use decisions. Many of the policies and recommendations cross element boundaries and work together toward overall implementation strategies. Refer to Section 9.5 for an explanation of the strategies cited as sources for many of the policies and recommendations.

Policies identify the way in which activities are conducted in order to fulfill the goals and objectives. Policies that direct action using the word "shall" are advised to be mandatory and regulatory aspects of the implementation of the comprehensive plan. In contrast, those policies that direct action using the words "will" or "should" are advisory and intended to serve as a guide. "Will" statements are considered to be strong guidelines, while "should" statements are considered loose guidelines.

Recommendations are specific actions or projects that the town should be prepared to complete. The completion of these actions and projects is consistent with the town's policies, and therefore will help the town fulfill the comprehensive plan goals and objectives.

Policies and Recommendations

1. Agriculture should be supported as a vital component of the county's economic base.
2. Forestry should be supported as a vital component of the county's economic base.
3. Tourism should be supported as a vital component of the county's economic base.
4. Commercial development should be steered to areas consistent with the local Preferred Land Use Plan Maps and associated recommendations.
5. Highway corridor development shall be directed to designated planned commercial areas and address building signage, lighting, service and land use standards.
6. Ensure that there is an adequate supply of serviceable commercial and industrial land located close to adequate transportation services.
7. Future economic development should be located in and/or directed toward areas within which adequate public facilities and services already exist, are programmed for expansion, or will be provided concurrent with development.
8. Industrial development should be steered to villages capable of providing sewer and water services.
9. The development of industrial areas will be preceded by a site development and long term industrial plan for the community. Public involvement will be required during the formation of any such plans.
10. Encourage industries that provide educational and training programs and those that provide family- and high-wage employment. Maintain and expand public, private, and partnership programs that will provide skilled workers for higher paying jobs.
11. The county will encourage economic development through public-private partnerships that are beneficial to the sustainability of the county and its communities and consistent with the comprehensive plan.
12. The development of economic area plans will be encouraged within the planning period, for example; downtown redevelopment plans, highway commercial corridor plans, etc.
13. Encourage the development of village downtown steering committees made up of merchants, bankers, public officials, chamber of commerce, and civic groups, whose purpose is to develop a shared vision for the downtown, and provide leadership in the downtown revitalization effort.

6.7 Economic Development Programs

For descriptions of economic development programs potentially available to the community, refer to the *Economic Development* element of the *Burnett County Inventory and Trends Report*.

7. Intergovernmental Cooperation

7.1 Intergovernmental Cooperation Plan

From cooperative road maintenance, to fire protection service districts, to shared government buildings, Burnett County and its communities have a long history of intergovernmental cooperation. As social, economic, and geographic pressures affect change in the Town of Dewey, the community will increasingly look to cooperative strategies for creative and cost-effective solutions to the problems of providing public services and facilities.

Intergovernmental cooperation is any arrangement by which officials of two or more jurisdictions coordinate plans, policies, and programs to address and resolve issues of mutual interest. It can be as simple as communicating and sharing information, or it can involve entering into formal intergovernmental agreements to share resources such as equipment, buildings, staff, and revenue. Intergovernmental cooperation can even involve consolidating services, consolidating jurisdictions, modifying community boundaries, or transferring territory. For further detail on intergovernmental cooperation in the Town of Dewey and Burnett County, please refer to Chapter 7 of the *Inventory and Trends Report*.

The Town of Dewey's plan for intergovernmental cooperation is to continue to rely on intergovernmental arrangements for the efficient provision of community facilities and services, to improve the planning and regulation of development along community boundaries, and to continue ongoing communication with other units of government. The Town of Dewey has been involved in intergovernmental cooperation with Burnett County and neighboring jurisdictions for many years, but hopes to build on these past successes to accomplish even more in the future. Top issues and opportunities identified during the planning process (refer to the *Issues and Opportunities* element) include _____

In order to implement the town's plan for intergovernmental cooperation, this plan recommends continuing to meet and plan together on a multi-jurisdictional basis. Over the long term, the town will continue to support sharing of services and facilities where there are sustainable benefits to town taxpayers. The town will also review opportunities to share equipment with neighboring jurisdictions, pursue cost-sharing or purchase agreements to help drive down costs, and review opportunities to consolidate services while maintaining service levels. The town may also pursue a cooperative boundary plan between with the Village for the area around State _____. The town will consider wellhead protection as a priority when reviewing development proposals in municipal well recharge areas.

7.2 Inventory of Existing Intergovernmental Agreements

The following recorded intergovernmental agreements apply to the Town of Dewey.

- ♦ Winter maintenance and other services agreement with Burnett County Highway Department, 2004
This agreement establishes a service agreement with the County Highway Department for winter maintenance and similar work for X miles of highway and road located in the _____

town. Services are paid by the town on a time and materials basis with a minimum contract total for one year of \$900 per mile of road.

- ♦ Agreement establishing Burnett Area fire district, 1999
This agreement documents the creation of the Burnett Area Fire District. It establishes a fire district commission and sets forth its operating procedures. The agreement proportionately divides among the participating communities (based on the assessed value of property) the responsibility for providing the fire district's budgeted costs.
- ♦ Cooperation agreement for Burnett Regional Recycling/Composting Center, 1990
This agreement documents _____'s participation in the Burnett Regional Recycling/Composting Center. It establishes a commission and sets forth operating procedures. The agreement proportionately divides among the participating communities (based on the assessed value of property) the responsibility for providing the center's budgeted costs.

7.3 Analysis of the Relationship with School Districts and Adjacent Local Governmental Units

School Districts

The Town of Dewey is located within the Webster School District, and generally has a good relationship with the district.

Burnett County and its communities maintain cooperative relationships with their school districts. Partnership between communities and schools is seen in the use of school athletic facilities that are open for use by community members. [Need to expand this section]

Lake Protection and Sanitary Districts

[Need more information]

Adjacent Local Governments

[Need more information about relationships and formal agreements with neighboring jurisdictions]

St Croix Chippewa Tribe

Burnett County maintains a cooperative relationship with the St. Croix Tribe. The Burnett County Human Services Division has several agreements for shared service, including providing home delivered meals---“meals on wheels”---for members of the tribe, shared programs through the Mental Health/Alcohol and Other Drug Abuse, and joint public health preparedness programs.

7.4 Intergovernmental Opportunities, Conflicts, and Resolutions

Intergovernmental cooperation opportunities and potential conflicts were addressed as part of the comprehensive plan development process. The entire structure of the multi-jurisdictional planning process was established to support improved communication between communities and increased levels of intergovernmental coordination. Communities met together in regional clusters to develop their comprehensive plans in a process described in Chapter 1 of the *Inventory and Trends Report*.

The intent of identifying the intergovernmental opportunities and conflicts shown below is to stimulate creative thinking and problem solving over the long term. Not all of the opportunities shown are ready for immediate action, and not all of the conflicts shown are of immediate concern. Rather, these opportunities and conflicts may further develop over the course of the next 20 to 25 years, and this section is intended to provide community guidance at such time. The recommendation statements found in each element of this plan specify the projects and tasks that have been identified by the community as high priorities for action.

Opportunities

Opportunity	Potential Cooperating Units of Government
♦ Develop plan implementation ordinances and other tools simultaneously	Burnett County Village of _____ Town of _____ Town of _____ Town of _____
♦ Assistance in rating and posting local roads for road maintenance and road improvement planning	Burnett County

Opportunity	Potential Cooperating Units of Government
♦ Utilize a coordinated process to update and amend the comprehensive plan	Burnett County Village of _____ Town of _____ Town of _____ Town of _____
♦ Work with the school district to anticipate future growth, facility, and busing needs	Burnett School District
♦ Share the use of school district recreational and athletic facilities	Burnett School District Village of _____ Town of _____ Town of _____ Town of _____
♦ Seek a cooperative solution for needed improvements to town hall facilities	Village of _____ Town of _____ Town of _____ Town of _____
♦ Share excess space at the town garage	Village of _____ Town of _____ Town of _____ Town of _____
♦ Share community staff	Village of _____ Town of _____ Town of _____ Town of _____
♦ Share office equipment	Village of _____ Town of _____ Town of _____ Town of _____
♦ Share construction and maintenance equipment	Village of _____ Town of _____ Town of _____ Town of _____
♦ Continue to coordinate shared services and contracting for services such as police protection, solid waste and recycling, recreation programs, etc.	Village of _____ Town of _____ Town of _____ Town of _____
♦ Reduce conflict over boundary issues through cooperative planning	Village of _____ Town of _____ Town of _____ Town of _____
♦ Develop a boundary agreement with the Village in the _____ area.	Village of _____
♦ Obtain a greater share of the property tax revenue for annexed lands	Village of _____

Opportunity	Potential Cooperating Units of Government
♦ Reduce development pressure on productive lands and rural character by directing growth to urban areas	Village of _____ _____ Sanitary District
♦ Improve the attractiveness of community entrance points	Burnett County Village of _____ Town of _____ Town of _____ Town of _____

Potential Conflicts and Resolutions

Potential Conflict	Process to Resolve
♦ Annexation conflicts between the town and the Village of _____	Distribution of plans and plan amendments to adjacent and overlapping governments Establishment of local Plan Commissions in every Burnett County community - joint community Plan Commission meetings Continued meetings of the County Planning Committee with representation from every Burnett County community
♦ Concern over too much intervention by Burnett County and the state relative to local control of land use issues.	Adopt a local comprehensive plan Take responsibility to develop, update, and administer local land use ordinances and programs Maintain communication with Burnett County on land use issues Provide ample opportunities for public involvement during land use planning and ordinance development efforts
♦ Siting of large livestock farms near incorporated areas	Town to consider establishing an Agriculture/Urban Interface area that prevents new farms over 500 animal units from locating within ½ mile of incorporated areas Burnett County to administer ACTP51 performance standards for livestock operations over 500 animal units

Potential Conflict	Process to Resolve
♦ Residential development planned adjacent to agriculture or forestry enterprise areas across a town boundary	<p>Distribution of plans and plan amendments to adjacent and overlapping governments</p> <p>Establishment of local Plan Commissions in every Burnett County community - joint community Plan Commission meetings</p> <p>Continued meetings of the County Planning Committee with representation from every Burnett County community</p>
♦ Concern over the ability or willingness of Burnett County to implement the recommendations of town plans	<p>Distribution of plans and plan amendments to adjacent and overlapping governments</p> <p>Continued meetings of the County Planning Committee with representation from every Burnett County community</p> <p>After plan adoption, a locally driven process to develop revisions to the county zoning and land division ordinances</p>
♦ Vastly different zoning and land division regulations from one town to the next	<p>Distribution of plans and plan amendments to adjacent and overlapping governments</p> <p>After plan adoption, a locally driven process to develop revisions to the county zoning and land division ordinances</p> <p>Continued meetings of the County Planning Committee with representation from every Burnett County community</p>
♦ Low quality commercial or industrial building and site design along highway corridors, community entrance points, or other highly visible areas	<p>Establishment of local Plan Commissions in every Burnett County community - joint community Plan Commission meetings</p> <p>Continued meetings of the County Planning Committee with representation from every Burnett County community</p> <p>Cooperative design review ordinance development and administration</p>
♦ Concern over poor communication between the town and the sanitary district	<p>Distribution of plans and plan amendments to adjacent and overlapping governments</p>

Potential Conflict	Process to Resolve
♦ Concern over poor communication between the town and lake districts	Distribution of plans and plan amendments to adjacent and overlapping governments
♦ Concern over poor communication between the town and the school district	Distribution of plans and plan amendments to adjacent and overlapping governments

7.5 Intergovernmental Cooperation Goals and Objectives

Community goals are broad, value-based statements expressing public preferences for the long term (20 years or more). They specifically address key issues, opportunities, and problems that affect the community. Objectives are more specific than goals and are more measurable statements usually attainable through direct action and implementation of plan recommendations. The accomplishment of objectives contributes to fulfillment of the goal.

Goal 1: Foster the growth of mutually beneficial intergovernmental relations between Burnett County and other units of government.

Objectives:

- A. Reduce the cost and enhance the provision of coordinated or consolidated public services and facilities with other units of government including the St. Croix Tribe.
- B. Continue the use of joint purchasing and shared service arrangements with other units of governments to lower the unit cost of materials and supplies for such things including, but not limited to, office supplies, roadwork supplies, vehicles, equipment, professional services, and insurance.

Goal 2: Foster the growth of mutually beneficial intergovernmental relations between local units of government within and outside of Burnett County.

Objectives:

- A. Provide leadership for community cooperation efforts in the comprehensive plan development, adoption, and implementation processes.
- B. Encourage and facilitate the use of cooperative agreements between municipalities for such things including but not limited to annexation, expansion of public facilities, sharing of services and property, and land use regulation.

7.6 Intergovernmental Cooperation Policies and Recommendations

Policies and recommendations build on goals and objectives by providing more focused responses to the issues that the town is concerned about. Policies and recommendations become primary tools the town can use in making land use decisions. Many of the policies and recommendations cross element boundaries and work together toward overall implementation

strategies. Refer to Section 9.5 for an explanation of the strategies cited as sources for many of the policies and recommendations.

Policies identify the way in which activities are conducted in order to fulfill the goals and objectives. Policies that direct action using the word “shall” are advised to be mandatory and regulatory aspects of the implementation of the comprehensive plan. In contrast, those policies that direct action using the words “will” or “should” are advisory and intended to serve as a guide. “Will” statements are considered to be strong guidelines, while “should” statements are considered loose guidelines.

Recommendations are specific actions or projects that the town should be prepared to complete. The completion of these actions and projects is consistent with the town’s policies, and therefore will help the town fulfill the comprehensive plan goals and objectives.

Policies and Recommendations

1. The county shall provide leadership to the process of local and county plan implementation through necessary staff, staff expertise, financing and technology.
2. The county shall work to maintain ongoing communication and positive relationships with its communities, school districts, sanitary districts, neighboring counties and communities, and state and federal agencies.
3. Transportation issues under the jurisdiction of the Burnett County Highway Department shall be jointly discussed and evaluated with the affected communities and if necessary, with the Wisconsin Department of Transportation.
4. Educational efforts regarding planning, land use regulation, implementation, or natural resource management should be discussed as multi-jurisdictional efforts between the county and local communities.
5. County facilities that have available capacity shall be considered for joint use with other units of government or community organizations.
6. The county shall consider intergovernmental and other cooperative options before establishing, reinstating, expanding, constructing or rehabilitating community facilities, utilities or services.
7. The county shall support the consolidation or shared provision of public services where the desired level of service can be maintained, where the public supports such action, and where sustainable cost savings can be realized.
8. Annually review intergovernmental agreements for their effectiveness and efficiency.
9. Maintain the County Planning Committee (CPC) as an active body for exploring intergovernmental plan implementation solutions and resolving intergovernmental conflicts. Convene a meeting of the CPC at least annually.

10. Continue cooperative planning efforts with surrounding towns, villages, districts, associations, service providers and the county.
11. A multi-jurisdictional planning effort will be considered when the comprehensive plan is updated.
12. The county will bi-annually evaluate the cost effectiveness of existing departments/offices or agencies which are independent of other government entities or where no intergovernmental agreements exist.
13. Before the purchase of new county facilities or equipment or the re-instatement of service agreements, the county will pursue options for trading, renting, sharing, or contracting such items from neighboring jurisdictions.
14. Opportunities for sharing county staff or contracting out existing staff availability will be pursued should the opportunity arise.
15. Any and all intergovernmental agreements or arrangements shall be in writing, and the statutory authority for such agreements will be identified.
16. The county shall provide leadership to the process of matching local land use plans and policies along municipal boundaries to promote consistency and minimize potential conflicts.
17. The county shall encourage cooperative boundary plans between villages and neighboring towns in compliance with Wis. Stats. 66.0307 within the planning period.
18. The county will encourage cooperative implementation of comprehensive plan policies and recommendations with all levels of government in Burnett County.

7.7 Intergovernmental Cooperation Programs

For descriptions of intergovernmental cooperation programs potentially available to the community, refer to the *Intergovernmental Cooperation* element of the *Burnett County Inventory and Trends Report*.

8. Land Use

8.1 Introduction

Land use is central to the process of comprehensive planning and includes both an assessment of existing conditions and a plan for the future. Land use is integrated with all elements of the comprehensive planning process. Changes in land use are not isolated, but rather are often the end result of a change in another element. For example, development patterns evolve over time as a result of population growth, the development of new housing, the development of new commercial or industrial sites, the extension of utilities or services, or the construction of a new road.

This chapter of the comprehensive plan includes local information for both existing and planned land use in the Town of Dewey. For further detail on existing land use in Burnett County, please refer to Chapter 8 of the *Inventory and Trends Report*.

8.2 Existing Land Use

Evaluating land use entails broadly classifying how land is presently used. Each type of land use has its own characteristics that can determine compatibility, location, and preference relative to other land uses. Land use analysis then proceeds by assessing the community development impacts of land ownership patterns, land management programs, and the market forces that drive development. Mapping data are essential to the process of analyzing existing development patterns, and will serve as the framework for formulating how land will be used in the future. Map 8-1, Table 8-1, and Figure 8-1 together provide the picture of existing land use for the Town of Dewey.

Table 8-1
Existing Land Use, Town of Dewey, 2008

Land Use Classification	Acres	Percent of Total
Residential	676	2.9%
Commercial	39	0.2%
Industrial	-	0.0%
Agricultural	9,509	40.4%
Forest / Open Space	12,329	52.3%
Tribal Land	86	0.4%
Surface Water	557	2.4%
Roads	367	1.6%
Total	23,563	100.0%

Source: Burnett County, Wisconsin Department of Revenue (2007 Statement of Assessments as Reported on or Before 3-04-08), and Foth.

Figure 8-1
Existing Land Use, Town of Dewey, 2008

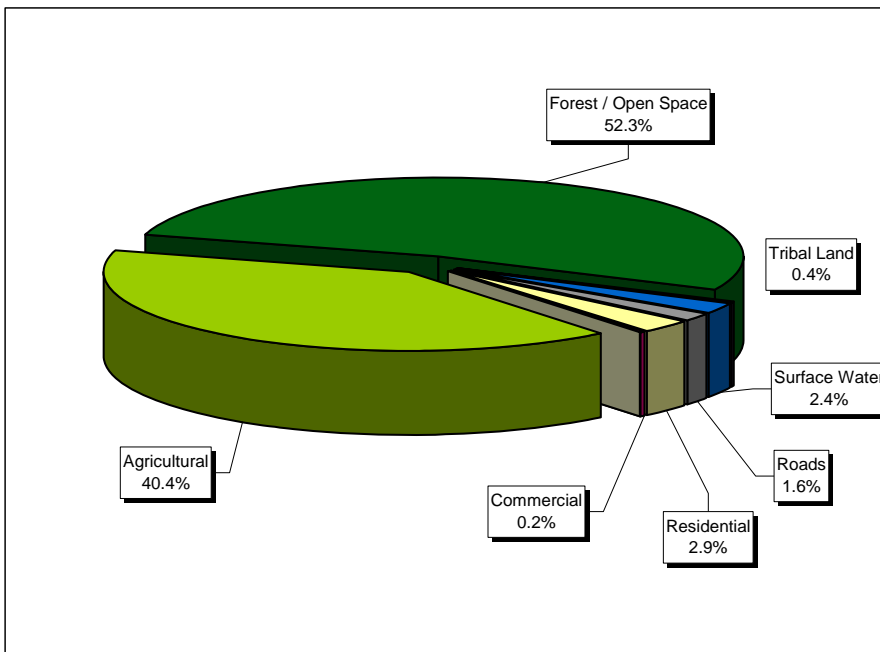

Source: Burnett County, Wisconsin Department of Revenue (2007 Statement of Assessments as Reported on or Before 3-04-08), and Foth.

This page intentionally left blank.

Map 8-1 Existing Land Use

This page intentionally left blank.

The Town of Dewey, with about 23,563 acres, is roughly the size of a typical 36-section town.. The town's development pattern is diverse as influenced primarily by soil conditions. The Town of Dewey is still primarily an undeveloped, rural town, and passive land uses include about 90% of the town's landscape. Forest/open space is the single largest existing land use at 12,329 acres (52.3%), while agricultural uses comprise about 9,509 acres (40.4%).

Developed uses make up just greater than 95% of the town's landscape including residential, commercial and roads. Residential is the single largest developed land use at 676 acres, and is dispersed throughout the town with notable concentrations of housing surrounding the town's lakes and along/near roads.

Of note is a trend toward the conversion of seasonal homes along the town's lakeshores to larger, year-round homes. Recent development in the town has been primarily residential, as new commercial and manufacturing development has a tendency to generally locate within the three Burnett County Villages.

8.3 Land Ownership and Management

Land ownership and management is comprised of several components that significantly affect land use. The type of land ownership (public, private, land trust, etc.) has a direct impact on how property is managed and how lands may be used in the future. Public ownership of land in Burnett County consists of municipal, county, and state owned lands. As land management takes place under both private and public ownership, resource management programs may prescribe certain requirements and limitations that affect how lands may be used in the future. Voluntary land and resource management protection programs with significant utilization on private lands in Burnett County include Managed Forest Land (MFL) and Forest Crop Land (FCL). Table 8-2 below shows land ownership and management in the Town of Dewey.

Understanding land ownership and management patterns provides a link to a host of voluntary and non-regulatory plan implementation tools. Valued community features and resources can be protected for future generations not only through regulatory approaches like zoning and land division ordinances, but also through public ownership or programs like MFL and FCL. Burnett County will be best positioned to achieve its desired future when land use, land management, and land regulation are working in concert.

Table 8-2
Land Ownership and Management

	Acreage	Percent of Total
County Lands	0.0	0.0%
Federal Lands	0.0	0.0%
State Land	394.4	1.7%
Tribal Lands	86.1	0.4%
Private Managed Forest Crop Land and Forest Land	0.0	0.0%
Land Not Under State, Federal, County, Tribal or Private Agricultural Ownership and Management	23,082.4	98.0%
Total Town Acreage	23,562.9	100.0%

Source: Burnett County

8.4 Projected Supply and Demand of Land Uses

Table 8-3 includes estimates for the total acreage that will be utilized by residential, agriculture, commercial, manufacturing, and forest/open space land uses in five-year increments through 2030. These future land use demand estimates are largely dependent on population projections and should only be utilized for planning purposes in combination with other indicators of land use demand.

The housing unit projection approximates the number of new residential units for the residential land demand projection, and is based on averaging the population projections (using both the WDOA and linear projection methods). Refer to the *Population and Housing* element for more details on population projections. Using the population projections, seasonal and vacant housing percentages, and average persons per household in the town, the housing unit projections are calculated. Using this method, a total of 46 new homes between 2008 and 2030 are projected in the town. The residential land use demand projection then assumes that each new home will occupy an average area of 2.1 acres. This existing average acreage is calculated by dividing the total residential assessed land by the total number of housing units (This plan actually specifies a range of residential lot sizes and densities within the Future Land Use Management Areas outlined in Section 8.8, the existing average is only for estimating purposes). This equates to an additional 96 residential acres by the year 2030.

Projected demand for commercial and industrial land use assumes that the ratio of the town's population to land area in these categories will remain the same in the future. In other words, each person will require the same amount of land for each particular land use as he or she does today. These land use demand projections also rely on averaging the population projections. Refer to the *Population and Housing* element for more details on population projections. This

equates an additional 7 acres for commercial use and no additional acres for industrial use by the year 2030.

Projected agriculture and forest/open space use acreages are calculated based on the assumption that these uses will decrease over time. Agriculture, woodlots, and other open land are the existing land uses that are converted to other uses to accommodate new development. The amount of agriculture and forest/open space land consumed in each five-year increment is based on the average amount of land use demand for each of the developed uses by the year 2030. In other words, a total of 103 acres per year is projected to be consumed by residential, commercial, and industrial development in the Town of Dewey between 2008 and 2030, so agriculture and forest/open space lands are reduced by the same number within the same time period. This number is subtracted proportionally from both of these land uses based on the 2008 ratio of each.

Table 8-3
Projected Land Use Demand (acres)
Town of Dewey 2008-2030

	2008 Estimate	2010 Projections	2015 Projections	2020 Projections	2025 Projections	2030 Projections	2008-2030 Change	%
Residential	676	688	713	736	756	772	96	14%
Commercial	39	40	41	43	44	46	7	18%
Industrial	0	0	0	0	0	0	0	0%
Agricultural	9,509	9,503	9,492	9,481	9,472	9,464	-45	0%
Forest/ Open Space	12,329	12,322	12,307	12,293	12,281	12,271	-58	0%
Tribal Land	86	86	86	86	86	86	0	0%
Other (Roads and Surface Water)	924	924	924	924	924	924	0	0%
Total Town Acreage	23,563	23,563	23,563	23,563	23,563	23,563		

Source: U.S. Bureau of the Census, WDOA, and Foth

Table 8-4 and Figure 8-2 provide a comparison of land supply and demand for the Town of Dewey. Land use demand is based on the previous calculations, and land supply is based on the future land use plan described in Section 8.7.

Table 8-4
Land Supply and Demand Comparison
Town of Dewey

TABLE TO BE ADDED

¹ Residential includes Rural Residential, Shoreland Residential, and 10% of Agriculture Enterprise, and Forestry Residential.

Figure 8-2

Land Supply and Demand Comparison
Town of Dewey

CHARTS TO BE ADDED

A sufficient supply of residential land has been planned through 2030 and beyond within the Future Land Use Management Areas based on the projected residential demand. Important to note is that while the Future Land Use Management Areas allow the potential for a significant amount of residential development across the town, the actual amount of development will be limited by demand. In addition, residential development will be managed in accordance with the Future Land Use Management Areas outlined in Section 8.8.

There are no areas planned directly for commercial use, but demand can met within the Shoreland Residential (SR) area that allows limited compatible commercial uses and through home based businesses if compatible within the town's rural and residential areas.

8.5 Density Management - A Different Approach to Managing Development

Burnett County manages growth through a zoning code that generally regulates the types of uses allowed and the associated minimum lot sizes that are required. This Plan and the County Plan advocates an approach to establish certain maximum densities for development within some of the planned rural and use designations as managed by Burnett County ordinances. Specific recommendations are included within the Future Land Use Management Areas outlined in Section 8.8.

It is critical to understand the difference between how density is used to manage development in comparison to minimum lot size. Minimum lot size requirements set how big individual lots need to be. Maximum density requirements set how many new homes or lots can be divided from a larger parcel, regardless of how big individual homesites or lots need to be. Establishing density standards typically works in conjunction with minimum lot sizes (and sometimes maximum lot sizes) to ensure the goals of the area (such as very low density in the agriculture enterprise classification) are met while ensuring standards are applied for health and safety (minimum lot size areas for adequate septage treatment and replacement). For more information refer to the *Burnett County Comprehensive Plan*.

8.6 Cluster/Conservation Development

In concert with adding density management provisions to achieve town and county goals of farmland preservation and maintaining rural character, the town and county should also consider adding residential clustering/conservation provisions as a primary development option for rural land development. Clustering typically allows relatively small residential lots, but still large enough to ensure adequate septage treatment and replacement systems. Clustering residential lots on a portion of a development tract (in conjunction with density management) allows a number of benefits including the conservation of farmland, forest, open space and natural resources, the ability to place homesites where the most suitable soils exist, and the potential for lower infrastructure costs. For more information refer to the *Burnett County Comprehensive Plan*. The following images show the difference between conventional residential lot development and cluster/conservation development:

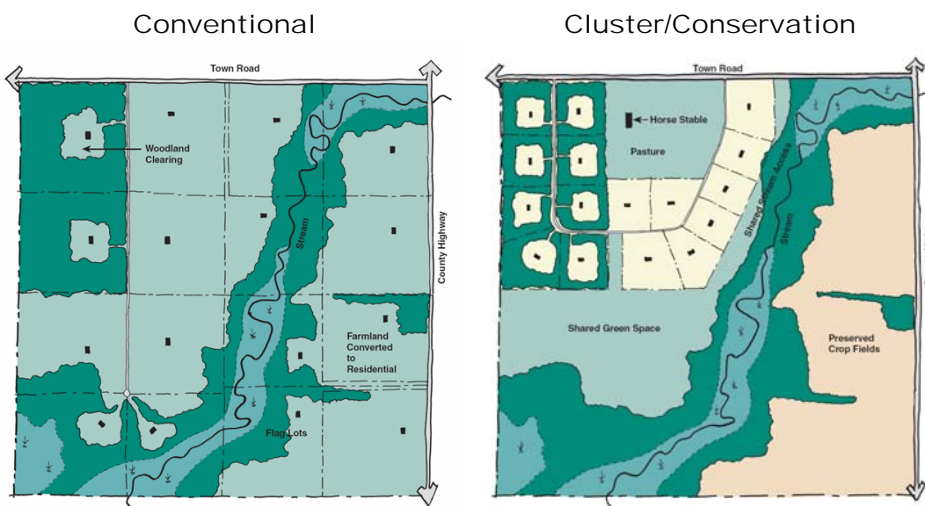

8.7 Future Land Use Plan

The future land use plan is one of the central components of the comprehensive plan that can be used as a guide for local officials when considering community development and redevelopment proposals. When considering the role of the future land use plan in community decision making, it is important to keep the following characteristics in mind.

- ♦ A land use plan is an expression of a preferred or ideal future – a vision for the future of the community.
- ♦ A land use plan is not the same as zoning. Zoning is authorized and governed by a set of statutes that are separate from those that govern planning. And while it may make sense

to match portions of the land use plan map with the zoning map immediately after plan adoption, other portions of the zoning map may achieve consistency with the land use plan incrementally over time.

- ♦ A land use plan is not implemented exclusively through zoning. It can be implemented through a number of fiscal tools, regulatory tools, and non-regulatory tools including voluntary land management and community development programs.
- ♦ A land use plan is long range and will need to be reevaluated periodically to ensure that it remains applicable to changing trends and conditions. The plan is not static. It can be amended when a situation arises that was not anticipated during the initial plan development process.
- ♦ A land use plan is neither a prediction nor a guaranty. Some components of the future vision may take the full 20 to 25 years to materialize, while some components may never come to fruition within the planning period.

The primary components of the future land use plan include the Future Land Use Map (Map 8-2) and the Future Land Use Management Areas. These components work together with the Implementation element to provide policy guidance for decision makers in the town.

The Town of Dewey's plan for future land use is intended to protect agricultural, natural, and cultural resources for future generations while also allowing reasonable opportunities for land development and making efficient use of existing infrastructure. The town will accomplish this by managing the use of lands and the density of development. Most locations in the town will allow for development to take place, but the density of development will be planned in order to preserve valued features of the landscape and to encourage growth in areas that are most suitable for development.

The future land use plan was shaped by both objective data and local opinion. Public participation in the form of public meetings and a county-wide survey was utilized to significantly impact the outcome. The town considered the locations of natural resources, agriculture, roads, current land use patterns, land ownership patterns, and other objective factors to measure suitability of lands for various future land uses. A draft map was prepared that was reviewed by the public. Changes to the draft plan suggested by the town citizens were evaluated by the planning commission, and the Town Board, and any accepted changes were incorporated into the plan.

Map 8-2 Future Land Use

This page intentionally left blank.

8.8 Future Land Use Management Areas

The following Future Land Use Management Areas (LUMAs) have been utilized on the town's Future Land Use Map. These descriptions give meaning to the map by describing (as applicable) the purpose, primary goal, preferred development density, preferred uses, and discouraged uses for each management area. They may also include policy statements that are specific to areas of the community mapped under a particular LUMA. Any such policies carry the same weight and serve the same function as policies found elsewhere in this plan.

Agricultural Enterprise (AE)

- ♦ Purpose: To prevent the conversion of agricultural land to other uses that are not consistent with agriculture while optimizing agricultural production areas. The purpose is also to implement comprehensive plan goals by encouraging livestock and other agricultural uses in areas where soil and other conditions are best suited to these agricultural pursuits. This area provides consistency with the County designated farmland preservation areas and establishes the farm and woodlands character of this part of the County.
- ♦ Primary Goal: To preserve and promote a full range of agricultural uses. In addition, this management area is intended to maintain a viable agricultural base to support the agricultural processing and service industries, help control public service costs in rural areas thereby avoiding the need to extend urban services to scattered, isolated residential areas, help to preserve productive soils, and help to maintain the scenic beauty, rural character, and cultural heritage of the community.
- ♦ Preferred Use: All agricultural uses, regardless of size. Specific preferred uses could include livestock production, dairy, agriculturally-related residences, greenhouses, horse facilities, agriculture sales and service, agricultural storage, agricultural research and development, fish and wildlife management activities, timber harvest and milling, and aqua culture. Sand and gravel extraction and home based businesses would be permitted in accordance with county regulations governing such activity. The Agricultural Enterprise Management Area could include a limited amount of residential development at various levels of density, but the predominant land use would be agricultural in nature.
- ♦ Recommended Policies:
 - ▶ The preferred housing density should range from 1 unit per 20 acres to 1 unit per 40 acres.
 - ▶ In areas identified by a town with the AE future land use management areas, new non-farm residential development should be placed on the landscape in a fashion that prevents conflicts between agricultural and residential land uses.
 - ▶ Promote clustering of homes and preservation of land for open space use within mapped agriculture enterprise areas.
 - ▶ Utilize maximum and minimum lot size provisions to ensure the lots created are large enough to accommodate development (say one acre) and yet small enough not to consume prime agricultural lands (say 3 or 5 acres).

- ▶ Consider soil characteristics when siting new buildings to maintain as much of the prime soils in production as possible.
- ▶ Encourage new development that is allowed in agricultural enterprise to be designed located in a manner that does not detract from the area's rural character, and which may be easily served by county, town, and emergency services. The county may want to work with interested towns in developing a driveway ordinance that guides the placement of driveways in new developments. For example, new driveways could be placed along existing contours, property lines, fencerows, lines of existing vegetation, or other natural features wherever possible.

Private Resource (PVR)

- ♦ Purpose: To accommodate the long term use of privately owned working lands, recreation areas (golf courses, gun clubs, etc.) that are intended for recreation or resource management.
- ♦ Primary Goal: Maintain a low development density that will support many of the features and activities residents and property owners enjoy in conjunction with reducing service costs to local taxpayers. Objectives of the PVR Management Area would include maintaining the rural character of the area, accommodating local conservation land and associated land management such as Quality Deer Management (QDM) programs, accommodating private forestry efforts, reducing forest fragmentation, accommodating quality outdoor recreational experiences and limit sporadic development that is inefficient for the town to service.
- ♦ Preferred Use: Conservation club lands, lands in forest management, private recreation lands such as golf courses etc.
- ♦ Recommended Policies:
 - ▶ The preferred housing density should range from 1 unit per 20 acres to 1 unit per 40 acres.
 - ▶ New residential development shall be placed on the landscape in a fashion that prevents conflicts between forest management and outdoor recreation land uses and residential land uses.
 - ▶ Promote clustering of homes and preservation of land for open space, natural resources, and recreational uses.
 - ▶ New development shall be placed on the landscape in a fashion that minimizes the fragmentation of large forest tracts.
 - ▶ New residential subdivisions with 5 lots or more shall not be allowed in areas planned for Private Resource unless site planning or conservation design can be effectively used to minimize negative impacts to forestry and outdoor recreation.

Rural Residential (RR)

- ♦ Purpose: To maintain the rural and open character of these areas while accommodating limited residential uses. Rural residential activity has been significant as the off lake property becomes more in demand for seasonal use. This area includes marginal or

abandoned farmlands that have become attractive for rural residences.

- ♦ Primary Goal: Preserve agriculture, the rural landscape, open space, and natural features of the area, while accommodating limited residential development. Promote infill of areas which have already experienced development in order to increase overall density without sacrificing community character.
- ♦ Preferred Use: Agricultural uses, with some size limitations. Limited residential development generally located along existing roadways, in clusters, and on larger lots than found in an urban area. Commercial uses are discouraged except those of very low intensity such as golf courses or home-based businesses.
- ♦ Recommended Policies:
 - The preferred housing density should range from 1 unit per 5 acres to 1 unit per 10 acres.
 - Lots smaller than one acre should be allowed with conservation or cluster design.
 - Density bonuses for conservation or cluster design should be considered.

Shoreland Residential (SR)

- ♦ Purpose: To recognize the shore lands adjacent to lakes, rivers, and streams in Burnett County as areas historically prone to development pressure. Many of the shorelands are significantly developed with both full-time and seasonal residents. Further residential development is regulated by the lakes and rivers classification development standards and accompanying shoreland ordinances.
- ♦ Primary Goal: Establishing appropriate strategies for the management of future development of these areas that address: ensuring environmental quality, maintaining views and open space, maintaining community character, and potential recreational activity conflicts.
- ♦ Preferred Use: Residential uses that are compatible with their immediate surroundings. Limited commercial uses including lodging, resorts and associated retail and services should be compatible with immediate surroundings and located in areas of established commercial uses.
- ♦ Recommended Policies: Stay consistent with Lakes Classification strategy for lot size and density.

Forestry Residential (FR)

- ♦ Purpose: To maintain the character, and viability of forestry of private forest lands while accommodating limited residential uses. The forestry residential areas are private forest lands adjacent to public forest holdings.

- ♦ Primary Goal: Maintain the area as primarily well-managed large parcels of contiguous land to ensure the viability of forestry uses, while accommodating limited residential development. Promote infill of areas which have already experienced development in order to increase overall density without sacrificing community character and causing further fragmentation of parcels.
- ♦ Preferred Use: Forestry uses, agricultural uses, with some size limitations. Limited residential development generally located along existing roadways, in clusters, and integrated with the natural landscape. Commercial uses are discouraged.
- ♦ Recommended Policies: The preferred housing density should range from 1 unit per 20 acres to 1 unit per 40 acres.
 - New development shall be placed on the landscape in a fashion that minimizes the fragmentation of large forest tracts.
 - Promote clustering of homes and preservation of land for open space and forestry.
 - Lots smaller than one acre should be allowed with conservation or cluster design.
 - New residential subdivisions with 5 lots or more should not be allowed in areas planned for forestry residential unless site planning or conservation design can be effectively used to minimize negative impacts to forestry.

Rural Mixed Use/Hamlet (RMU)

- ♦ Purpose: To recognize the places of A&H, Alpha, Danbury, Falun, Hertel, and Anderson as small growth areas that have historically been crossroad communities that provide convenience and rural retail services to farm and lake recreation areas.
- ♦ Primary Goal: To maintain and allow the limited growth (except where urban services exist such as the sewer services area in Danbury) of these areas in a fashion that strengthens the existing identity and character.
- ♦ Preferred Use: A mix of residential and commercial uses could be allowed at varying densities in accordance with the type of use. The density, layout, and design of development shall be
- ♦ Recommended Policies: Densities and lot sizes should be allowed to vary. For areas without public sewage service, the maximum density should be one home per three-quarter acre. For areas with public sewage, the minimum density should be one unit per acre.

General Commercial (GC)

- ♦ Purpose: To represent existing commercial land uses and anticipate limited future commercial areas located _____.
- ♦ Primary Goal: To accommodate commercial uses in areas that can support such activities while recognizing that the state highway corridors are important transportation elements to Burnett County and should be maintained as high speed arterials, and more intensive

commercial uses that require public services such as sewer and water should be located in a sanitary district or incorporated community.

- ♦ Preferred Use: Retail sales and services, eating and drinking establishments, professional offices, service and repair businesses, agriculture support businesses, entertainment, visitor accommodations, parking lots, and other commercial type uses.
- ♦ Recommended Policies:
 - Limit the areas of planned commercial uses to defined areas and corridors.
 - It should be a requirement that all proposed commercial projects submit a detailed site plan showing the proposed location of the building, parking, outdoor storage, loading, signage, landscaping, and lighting prior to development approval.
 - Require that all new commercial development be accessed by public roads.

Industrial (I)

- ♦ Purpose: To represent existing light and heavy industrial type land uses and anticipate limited future industrial areas.
- ♦ Primary Goal: To accommodate industrial uses in areas that can support such activities while recognizing that most industrial uses that require public services such as sewer and water should be located within sanitary districts, or within adjacent cities and villages.
- ♦ Preferred Use: Industrial uses such as manufacturing and production facilities, resource extraction and processing, warehousing, feed mills, wholesale establishments, and salvage and junk yards, and other industrial type uses.
- ♦ Recommended Policies:
 - These districts, due to actual physical and operational characteristics, need to be carefully established to ensure compatibility with surrounding areas. Compatibility would be determined by the evaluating the surrounding area or the county as a whole by reason of noise, dust, smoke, odor, traffic, physical appearance.
 - It should be a requirement that all proposed industrial or intensive commercial projects submit a detailed site plan showing the proposed location of the building, parking, outdoor storage, loading, signage, landscaping, and lighting prior to development approval.
 - New development should have associated design standards to adhere to high quality building design, generous landscaping, modest lighting, screened storage areas, and limited and attractive signage.
 - Require that all new commercial development be accessed by public roads.

Government/Institutional (GI)

- ♦ Purpose: To accommodate existing and future locations of government and institutional facilities.

- ♦ Primary Goal: To ensure that land is available for government and institutional uses in areas which best accommodate their use.
- ♦ Preferred Use: Public and private utility facilities as well as those uses which provide a service to the community, except parks. Land uses such as churches, cemeteries, post offices, libraries, nursing homes, assisted living facilities, water wells, water towers, wastewater treatment facilities, airports, hospitals, town/city/village halls, police and fire stations, museums, and schools are some examples.

Public Resource (PR)

- ♦ Purpose: A Land Use Management Area to designate existing public lands and wetlands that are not planned for development.
- ♦ Primary Goal: To maintain natural features and areas as community assets and conserve these features for future generations. In addition, to prohibit development in areas which are not suited.
- ♦ Preferred Use: Allowable uses may include forestry, passive recreation, wildlife protection activities, and fisheries as possible uses.

Planned Urban Transition (PUT)

- ♦ Purpose: To plan for areas adjacent to incorporated communities in accordance with designated planned Sewer Service Areas where residential, commercial or other uses will occur at higher densities. The Management Area will have short or long term potential for public services or shared services between the town and the village as identified within the village's comprehensive plan. The Planned Urban Transition Area is intended to promote intergovernmental cooperation with neighboring incorporated municipalities. It is further intended that the town and incorporated community in which the PUT LUMA area is adjacent pursues boundary agreements in these areas to define future land use, phasing of development, and the possibility for shared service agreements prior to any development.
- ♦ Primary Goal: To recognize the growth areas of villages and allow for their efficient growth into more rural areas in accordance with coordinated utility and other public services. Development within the planned transition area should be phased outward from the urban edge of the incorporated municipality.
- ♦ Preferred Use: Multiple uses on smaller urban sized lots.
- ♦ Recommended Policies: Densities and lot sizes should be allowed to vary. Recommended minimum density is one home per half acre. Density could be increased in accordance with Area Development Plans and access to appropriate public services.

Table 8-5 and Figure 8-3 display the distribution of each Future Land Use Management Area as shown on the Future Land Use Map.

Table 8-5
Future Land Use, Town of Dewey 2030

TABLE TO BE ADDED

Source: Town of Dewey.

Figure 8-3
Future Land Use, Town of Dewey 2030

CHART TO BE ADDED

Source: Town of Dewey

8.9 Existing and Potential Land Use Conflicts

The following existing and potential unresolved land use conflicts have been identified by the Town of Dewey. While the multi-jurisdictional planning process was designed to provide maximum opportunities for the resolution of both internal and external land use conflicts, some issues may remain. Due to their complexity, the long range nature of comprehensive planning, and the uncertainty of related assumptions, these conflicts remain unresolved and should be monitored during plan implementation.

Existing Land Use Conflicts

- ♦ Lack of property and building maintenance.
- ♦ Lack of land use ordinance enforcement.
- ♦ Telecommunication towers.
- ♦ Wind energy towers.
- ♦ Residential development next to high intensity agricultural land use and threats to the right-to-farm.
- ♦ Residential development next to extraction land uses.
- ♦ Poorly designed or unattractive commercial or industrial development.
- ♦ Lack of screening or buffering between incompatible uses.
- ♦ Home based businesses that take on the characteristics of primary commercial or industrial uses.
- ♦ The over-consumption of rural lands by large lot subdivisions.
- ♦ The loss of rural character in some locations.

Potential Land Use Conflicts

- ♦ Siting of undesirable or poorly designed land uses in the interim between plan adoption and development of implementation tools.
- ♦ Annexation conflicts may arise with the Village.
- ♦ Meeting the service needs of newly developed areas.
- ♦ Controlling and managing development along major highway corridors and interchanges.
- ♦ The over-consumption of rural lands by large lot subdivisions.
- ♦ The loss of rural character in some locations.

8.10 Opportunities for Redevelopment

In every instance where development is considered in the *Town of Dewey Year 2030 Comprehensive Plan*, redevelopment is also considered as an equally valid option. Infill development is the primary type of redevelopment that is likely in the town along.

8.11 Land Use Goals and Objectives

Community goals are broad, value-based statements expressing public preferences for the long term (20 years or more). They specifically address key issues, opportunities, and problems that affect the community. Objectives are more specific than goals and are more measurable statements usually attainable through direct action and implementation of plan recommendations. The accomplishment of objectives contributes to fulfillment of the goal.

Goal 1: Guide the efficient use of land through a unified vision of planned growth in recognition of resource limitations and County goals and objectives.

Objectives:

- A. Maintain a current, long-range comprehensive plan, which will serve as a guide for future land use and zoning decisions.
- B. Develop procedures and policies that ensure a balance between appropriate land use and the rights of property owners, focusing on the best interests of the county as a whole.
- C. Ensure all landowners have equitable options for proposing land use change.
- D. Coordinate land use planning and growth management throughout the county to facilitate efficient resource investments while allowing for local autonomy where warranted.
- E. Help identify, evaluate, and preserve historic, archaeological, and cultural resources.
- F. Coordinate archaeological inventories and management plans with Native American groups and other interested parties.
- G. Encourage village and town planning goals that are consistent with or do not conflict with County goals and policies.
- H. Identify areas of potential conflict between the land use plans of Burnett County and its communities and provide a process for the discussion and resolution of such conflicts.
- I. Establish agreements regarding land use regulation and provision of services in the growth areas outside existing villages addressing land uses, levels of service, resolution of boundary disputes, service extension policies, and transfer of jurisdictional burdens.

Goal 2: Plan for a desirable pattern of land use that contributes to the realization of the county's, towns', and villages' goals and objectives for the future.

Objectives:

- A. Restrict new development from areas shown to be unsafe or unsuitable for development due to natural hazards, contamination, access, or incompatibility problems.
- B. Establish a range of Preferred Land Use Management Areas and a range of preferred development densities and assign them to areas of the county in order to identify planning guidelines within which a variety of local land use planning and implementation options will achieve long term land use compatibility.
- C. Seek a pattern of land use that will preserve large tracts of productive agricultural areas and resources.
- D. Seek a pattern of land use that will preserve productive forestry areas and resources.
- E. Seek a pattern of land use that will preserve green spaces in developed areas, and natural resources, with a focus on groundwater and surface water resources.
- F. Seek a pattern of land use that will maintain and enhance the county economy.
- G. Focus areas of substantial new growth within or near existing areas of development where adequate public facilities and services can be cost-effectively provided or expanded.
- H. Encourage the centralization of commerce, entertainment, and employment to create vigorous community centers.
- I. Promote growth patterns that result in compact, distinct and separate communities rather than continuous linear strips of development.
- J. Encourage cluster development to assure conservation of land, efficient provision of public services, and accessibility.
- K. Encourage new development to be integrated with the surrounding landscape through visual prominence of natural features, use of natural materials and colors, and minimizing the development's impact on the natural environment.
- L. Help identify the full range of public facilities considered optimum for urban development such as water and sewer utilities, police and fire protection, health services, schools, parks, libraries, and solid waste collection and disposal services.
- M. Help promote the provision of public facilities and services when sufficient need and revenue base to support them exists.

- N. Consider a variety of planning tools such as area development plans, density management regulations, purchase or transfer of development rights programs, site and architectural design review guidelines, and voluntary land management programs to achieve the county's, towns', and villages' desired pattern of future land use.
- O. Encourage land division layouts that incorporate the preservation of valued community features, that fit within the character of the local community, and that are suited to the specific location in which the development is proposed.
- P. Require landscape and land use buffers to lessen the impacts of conflicting land uses in close proximity.
- Q. Require intensive uses such as salvage yards be screened from public view.
- R. Coordinate with the Department of Natural Resources and the National Park Service to ensure that land management decisions provide maximum benefits.

8.12 Land Use Policies and Recommendations

Policies and recommendations build on goals and objectives by providing more focused responses to the issues that the town is concerned about. Policies and recommendations become primary tools the town can use in making land use decisions. Many of the policies and recommendations cross element boundaries and work together toward overall implementation strategies. Refer to Section 9.5 for an explanation of the strategies cited as sources for many of the policies and recommendations.

Policies identify the way in which activities are conducted in order to fulfill the goals and objectives. Policies that direct action using the word "shall" are advised to be mandatory and regulatory aspects of the implementation of the comprehensive plan. In contrast, those policies that direct action using the words "will" or "should" are advisory and intended to serve as a guide. "Will" statements are considered to be strong guidelines, while "should" statements are considered loose guidelines.

Recommendations are specific actions or projects that the town should be prepared to complete. The completion of these actions and projects is consistent with the town's policies, and therefore will help the town fulfill the comprehensive plan goals and objectives.

Policies and Recommendations

1. The comprehensive plan shall identify anticipated areas for future growth, the preferred land uses within growth areas, and policies that guide the review of proposed developments.
2. The county preferred land use map shall be the equivalent of the most current locally adopted preferred land use map of each municipality in Burnett County. In other words, the local preferred land use map is the county preferred land use map for that area.

3. Work with towns to improve county zoning and land division ordinance provisions toward improved management of land use and development and toward overall comprehensive plan implementation.
 4. Expand and/or refine the menu of zoning districts for increased flexibility in the implementation of town plans. Work with towns to update the zoning map to provide improved consistency with the preferred land use map.
 5. Improve the administration of land division review in order to track all land divisions (plats, CSMs, and quit claim deeds) necessary to enforce density and other land management policies.
 6. County zoning, subdivision, and other land use ordinances shall be maintained and updated as needed to implement the Preferred Land Use Plan.
 7. All development proposals shall meet the intent of the Preferred Land Use Management Areas as described within the Land Use element.
 8. All development proposals shall meet the goals and objectives of the established Preferred Land Use Management Areas, as identified within the Land Use Element of the comprehensive plan.
 9. In order to coordinate consistency in the county-town plans, Burnett County shall request and consider town input and recommendations prior to making a decision on a rezone, conditional use, land division (including plats and certified survey maps), or site plan approval.
 10. Where a proposed development is found to be inconsistent with comprehensive plan policies, an applicant shall be advised to petition the local unit of government for a revision to the comprehensive plan preferred land use map (note: the applicant may also revise the design of the proposed development to attempt to achieve consistency with the plan).
 11. Where a proposed development is initially found to be inconsistent with comprehensive plan policies, but the town amends its map to accommodate the development, the county will not deny the application on the basis of inconsistency with the preferred land use plan.
 12. The siting and construction of new developments shall be consistent with the purpose, intent, preferred use, and preferred density established in the applicable Preferred Land Use Management Area and meet the applicable review criteria established by comprehensive plan policies.
 13. At a minimum, the following characteristics shall be used to define a cluster or conservation design development:
 - a. Residential lots or building sites are concentrated and grouped.
-

- b. The number of lots (density) takes into account the standards of the overlying zoning district.
 - c. The lot size is reduced from what is normally required.
 - d. A maximum lot size is employed to support open space requirements and manage density.
 - e. There are residual lands that are preserved as green space in perpetuity for the purpose of limiting density, protecting valued community features such as agriculture, natural resources, or cultural resources.
14. At such time that a home-based business takes on the characteristics of a primary commercial or industrial use, it shall be relocated, discontinued, or rezoned (as necessary) to be consistent with the applicable adopted comprehensive plan and overlying land use regulation (zoning) to appropriately reflect the a commercial or industrial use.
15. The county should review growth and development applications to address service demands on community services or facilities. (validate)
16. Proposed conditional uses shall meet the following criteria in order to gain county approval:
- a. Complies with the requirements of the applicable zoning district
 - b. Use and density are consistent with the intent, purpose, and policies of the applicable preferred land use management area.
 - c. Use and site design are compatible with adjacent uses in terms of aesthetics, scale, hours of operation, traffic generation, lighting, noise, odor, dust, vibration, and other external impacts
 - d. Does not diminish property values in the surrounding neighborhood
 - e. Provides assurance of continuing maintenance
 - f. Addresses parking and site layout requirements
17. Home-based business shall maintain the following characteristics:
- a. They are conducted in a zoning district where such use is allowed
 - b. They maintain compliance with the specific requirements of the zoning ordinance
 - c. They are a secondary use of a primarily residential property
 - d. They have little to no outward appearance or negative impact on the surrounding neighborhood
18. The design of new commercial and industrial development should employ shared driveway access, shared parking areas, shared internal traffic circulation, and coordinated site planning with adjacent businesses.
19. Commercial and industrial development should be directed to areas where existing public facilities and services are adequate to support growth, are planned for expansion, or will be provided concurrent with development.
20. New lots and building sites should be located and designed to protect environmental corridors, working woodlands and working farmland.

21. The county should consider distance restrictions of non-farm related residential structures to active agricultural operations (such as locating a minimum of 1,000 feet away from designated active farms and manure storage sites in order to avoid or lessen the potential for land use conflicts).
22. New commercial and industrial development should employ site and building designs that include:
 - a. Signage and building architecture;
 - b. Shared highway access points;
 - c. Parking and loading areas;
 - d. Landscaping;
 - e. Lighting;
 - f. Efficient traffic and pedestrian flow.
 - g. Location of large, bulky, box-like commercial structures shall be avoided.
 - h. Where possible, parking lots shall be placed behind buildings to lessen their visual impact on the community.
 - i. All mechanical equipment (i.e. air conditioners, ventilation equipment, etc.) should be screened from public view. This includes roof-top equipment and equipment on the ground.
 - j. Future business and industrial development in the county should be reviewed for potential financial, service and visual impacts to surrounding landowners.

8.13 Land Use Programs

For descriptions of land use programs potentially available to the community, refer to the *Land Use* element of the *Burnett County Inventory and Trends Report*.

Additional Programs

The following Burnett County programs are identified here, because implementation of the Town of Dewey's land use plan will require continued cooperation with the county. Revisions to the county zoning and land division ordinances are a likely outgrowth of the comprehensive planning process, which has also been identified as an intergovernmental cooperation opportunity in Section 7.4. Tracking development density over time, as is suggested in the Future Land Use Management Areas, will require cooperation with county land information systems.

Burnett County Zoning Department

The Burnett County Zoning Department provides zoning administration, issues zoning and land use permits, and houses information and maps of zoning districts, floodplains, shorelands, and wetlands. The Zoning Department issues all Sanitary Permits for the county and inspects all systems for compliance with state codes. The department also administers the Wisconsin Fund Grant Program which provides funding assistance for failing private sanitary systems. It also enforces a Subdivision Ordinance which regulates division of land parcels.

Burnett County Land Information Office

The Land Information Office was established within the Property Listing Office and is under the direction of the Land Information Office Coordinator. The coordinator's responsibilities include assuring the efficient integration of the land information system and the cooperation between federal and state Agencies, local governmental units, county departments, public and private utilities and the private sector.

9. Implementation

9.1 Action Plan

In order for plans to be meaningful, they must be implemented, so the Town of Dewey's comprehensive plan was developed with implementation in mind. Not only can useful policy guidance for local decision making be found in each planning element, but an action plan is also provided containing specific programs and recommended actions.

An action plan is intended to jump start the implementation process and to provide continued focus over the long term. During the comprehensive planning process, a detailed framework for implementation was created which will serve to guide the many steps that must be taken to put the plan in motion. This action plan outlines those steps and recommends a timeline for their completion. Further detail on each task can be found in the policies and recommendations of the related planning element as noted in the *Task* statement. Recommended actions have been identified in the following four areas:

- ♦ Plan Adoption and Update Actions
- ♦ Intergovernmental Cooperation Actions
- ♦ Ordinance Development and Update Actions
- ♦ Strategic Planning Actions

The recommended actions are listed in priority order within each of the four implementation areas as noted in the *Timing* component. Highest priority actions are listed first, followed by medium and long term actions, and ongoing or periodic actions are listed last.

Plan Adoption and Update Actions

Priority (Short Term) Actions

1. Task: Pass a resolution recommending adoption of the comprehensive plan by the Town Board (*Implementation* element).
Responsible Party: Plan Commission
Timing: November 2009 – February, 2010
2. Task: Adopt the comprehensive plan by ordinance (*Implementation* element).
Responsible Party: Town Board
Timing: February – March, 2010

Periodic Actions

1. Task: Review the comprehensive plan for performance in conjunction with the budgeting process (*Implementation* element).
Responsible Party: Plan Commission
Timing: Annually

2. Task: Conduct a comprehensive plan update (*Implementation* element).
Responsible Party: Plan Commission, Town Board
Timing: Every five years
Consideration: The 2010 census data will be available in 2011. The updated housing and population counts and projections can be applied and planning documents modified based on the new data.

Intergovernmental Cooperation Actions

Priority (Short Term) Actions

1. Task: Meet with other units of local government to assess/discuss plan review issues, implementation coordination, and consistency requirements (*Intergovernmental Cooperation* element).
Responsible Party: Town Board
Timing: 2010/2011 (within one to two years)

Medium Term Actions

1. Task: Distribute an intergovernmental cooperation update (*Intergovernmental Cooperation* element).
Responsible Party: Town Board
Timing: 2012 to 2015 (within three to five years)
2. Task: Review and evaluate existing intergovernmental agreements and services (*Intergovernmental Cooperation* element).
Responsible Party: Plan Commission and Town Board
Timing: 2012 to 2015 (within three to five years)

Long Term Actions

1. Task: Work with Burnett County to create a Purchase of Development Rights PDR Program or Donated Easement Program (*Agricultural, Natural, and Cultural Resources* element).
Responsible Party: Plan Commission and Town Board
Timing: 2014 (five years or more)

Periodic Actions

1. Task: Utilize intergovernmental options to provide needed service and facility improvements.
Responsible Party: Town Board
Timing: Ongoing

Ordinance Development and Update Actions

Short Term Actions

1. Task: Work with Burnett County to modify the zoning ordinance and map toward implementation of the town's comprehensive plan (*Transportation; Utilities and Community Facilities; Agricultural, Natural, and Cultural Resources; Land Use* element).
Responsible Party: Plan Commission and Town Board
Timing: Anticipated late 2010 - 2012
2. Task: Work with Burnett County to modify the county land division ordinance toward implementation of the town's comprehensive plan (*Transportation; Utilities and Community Facilities; Agricultural, Natural, and Cultural Resources; Land Use* element).
Responsible Party: Plan Commission and Town Board
Timing: Anticipated late 2010 - 2012
3. Task: Adopt a driveway ordinance (*Transportation* element).
Responsible Party: Plan Commission and Town Board
Timing: 2011 (within two years)

Medium Term Actions

1. Task: Develop a site plan and architectural design review standards. The standards could be guidelines or an ordinance. Related provisions may be developed at the county level which may apply, therefore it is recommended the town work with Burnett County within the construct of the county zoning and land division ordinance updates prior to pursuing this strategy (*Agricultural, Natural, and Cultural Resources* element).
Responsible Party: Plan Commission and Town Board
Timing: 2012 to 2014 (within three to five years)

Long Term Actions

1. Task: Develop an official map (*Transportation* element). The need may not be applicable town-wide; consider designating road corridors for higher density development areas, lakeshore areas, or areas of long term planned development
Responsible Party: Plan Commission and Town Board
Timing: 2013-2014
2. Task: Consider development of a historic preservation ordinance (*Agricultural, Natural, and Cultural Resources* element).
Responsible Party: Plan Commission and Town Board
Timing: 2015 (five years or more)

Periodic Actions

1. Task: Update the town road construction specifications (*Transportation* element).
Responsible Party: Town Board
Timing: Periodic as needed

Strategic Planning Actions

Periodic Actions

1. Task: Review land use and density policies for residential development to ensure longer term plan recommendations are coordinated with shorter term market conditions (*Housing* element).
Responsible Party: Plan Commission
Timing: Annually
 2. Task: Review ordinances and fees for their impacts on town administration and development applicants (*Housing* element).
Responsible Party: Plan Commission
Timing: Annually
 3. Task: Update the five-year road improvement plan (*Transportation* element).
Responsible Party: Town Board
Timing: Annually
 4. Task: Pursue funding for transportation improvements (*Transportation* element).
Responsible Party: Town Board
Timing: Annually
 5. Task: Assess staffing, training, and equipment needs (*Utilities and Community Facilities* element).
Responsible Party: Town Board
Timing: Annually
 6. Task: Assess building and public facility capacity (*Utilities and Community Facilities* element).
Responsible Party: Town Board
Timing: Every five years
 7. Task: Maintain an inventory of active farms, feedlots, and manure storage facilities (*Agricultural, Natural, and Cultural Resources* element).
Responsible Party: Plan Commission
Timing: As needed
 8. Task: Maintain an inventory of historic and archeological sites (*Agricultural, Natural, and Cultural Resources* element).
Responsible Party: Plan Commission
Timing: As needed
-

9.2 Status and Changes to Land Use Programs and Regulations

The following provides an inventory of the land use regulations that are in affect in the Town of Dewey and summarizes recommended changes to each of these ordinance types. For basic information on regulatory plan implementation tools, please refer to Section 9.1 of the *Inventory and Trends Report*. For further detail on the status of each type of implementation ordinance in Burnett County, please refer to Section 9.3 of the *Inventory and Trends Report*.

Code of Ordinances

Current Status

The Town of Dewey has not adopted its ordinances as a code of ordinances. The town administers the following ordinances:

- ♦ Plan Commission Ordinance
- ♦ Driveway/Road Access Ordinance
- ♦ Licenses Ordinance
- ♦ (Our records indicate that we have no other ordinances on file from the Town, please verify from Town Clerk and list appropriately)
- ♦

Recommended Changes

Follow the statutory procedure for creating a code of ordinances. All existing and future ordinances should be adopted as part of the town's municipal code. The code is easier to manage and more efficient, especially during times of political and administrative succession or transition.

Zoning

Current Status

The Burnett County Zoning Ordinance establishes the county's basic land use, lot size, and building location and height requirements. The Burnett County Zoning Ordinance applies to unincorporated areas of the county in towns that have adopted the ordinance. To date, all towns except the Towns of Blaine, La Follette, Sand Lake, and Wood River have adopted the Burnett County Zoning Ordinance. The Town of Dewey's zoning information is displayed on Map 9-1 and Table 9-1.

Recommended Changes

Zoning ordinances will be one of the key tools that the Town of Dewey will need to utilize to implement its comprehensive plan. For the sake of efficiency and consistency, the town prefers to work with Burnett County to modify county zoning ordinances for achievement of the town's vision for the future. A more effective zoning ordinance will be utilized to:

- ♦ Promote housing options

- ◆ Preserve agricultural lands and the right to farm
- ◆ Preserve natural resources and cultural resources including rural character
- ◆ Implement the town's site planning policies
- ◆ Better achieve the town's desired development pattern
- ◆ Better manage potentially conflicting land uses.

Table 9-1 Zoning, Town of Dewey

Zoning Classification	Acreage	Percent of Total
A (Exclusive Agriculture District)	18,938.1	83.4%
A1 (Agriculture--Transition District)	0.0	0.0%
A2 (Agriculture--Residential District)	1,510.3	6.7%
A4 (AG\Forestry)\Residential District)	39.0	0.2%
AP (Airport District)	0.0	0.0%
C1 (Commercial District)	23.6	0.1%
F1 (Forestry District)	316.0	1.4%
I1 (Industrial District)	0.0	0.0%
PUD (Planned Unit Development)	0.0	0.0%
RR1 (Residential Recreational District #1)	1,419.0	6.3%
RR2 (Residential Recreational District #2)	5.3	0.0%
RR3 (Residential Recreational District #3)	28.2	0.1%
W1 (Resource Conservation District)	418.2	1.8%
Shoreland Zoning*	7,670.4	
TOTAL ZONED LAND**	22,697.7	100.0%
TOTAL TOWN LAND	23,562.9	

* Shoreland zoning is not counted in the total as it overlays the underlying zoning.

**Does not include unzoned land, tribal land, surface water, or roads.

Source: Burnett County

This page intentionally left blank.

Map 9-1 Existing Land Use Regulations

This page intentionally left blank.

On a fundamental level, the town will need to work with Burnett County to amend or create new zoning districts and to revise the town zoning map. This will help implement the town's preferred land uses and densities as established under the Future Land Use Management Areas. Coordination will be necessary between the towns in Burnett County as efficiency and cost management will be primary considerations at the county level.

Figure 9-2
County Zoning Coordination Evaluation Criteria

<h2>Zoning Draft Development: Coordination and Evaluation Criteria Critical to County/Town Mutual Benefits</h2>	
<p><u>Effectiveness</u> Effectiveness in implementing local and County Comprehensive Plans</p>	<p><u>Simplicity</u> Ease of understanding by the general public</p>
<p><u>Ease of Ongoing Administration and Cost Efficiency</u> Time and effort required to administer and use the density management system on a day to day basis</p>	<p><u>Flexibility</u> Amount of options available to individual towns to implement preferred land use management density and lot size provisions (within County Framework)</p>
<p><u>Ease of Initial Implementation and Cost Efficiency</u> Time, effort, and cost to initially implement the density management system</p>	<p><u>Potential for Success</u> Potential for success in achieving local and county goals – developing win-win solutions</p>

Burnett County and all towns under county zoning or considering adopting zoning administered through Burnett County will need to consider the evaluation criteria as represented in Figure 9-2. Each town in Burnett County has their own ideas on how to manage land use, but there is similarity in the goals in which the comprehensive plans were developed. The County and Town Comprehensive Plans were developed based on an overall county-wide framework to establish consistency across the county, yet provide enough local flexibility for towns to manage their respective community per their individual plan. Towns were encouraged to develop specific strategies and policies to best fit local needs during the planning process. The intent of coordination a County Zoning Ordinance update is to help implement both county and local plans by providing a framework of consistent regulations that will implement many of the local strategies and policies. Assuming the process will be coordinated similar to the county planning process, the Zoning Ordinance revisions will also provide many options for the Towns to customize the zoning districts to meet local needs while recognizing the constraints of administrative costs.

In regard to modifying or updating the zoning maps to help implement the comprehensive plan, the Future Land Use Map should not simply become the zoning map. The comprehensive plan and associated Future Land Use Map are not intended to be so detailed that they try to predict what the future land uses might be (no one has a crystal ball). The Future Land Use Map is intended to be more general to reflect the goals and capture the long term intent of creating or preserving community character. The Future Land Use Map should be kept more general and have written policy guidance for how to address rezonings, land division, development applications, etc. In many instances the plan goals, objectives, policies and recommendations will be more important than the future land use map as they collectively manage community decisions.

In addition to the revision of the basic zoning districts and map, the town hopes to employ several tools to help review and coordinate development including the following:

- ♦ Development review standards and processes
- ♦ Conditional use review criteria
- ♦ Site planning regulations (further detailed under *Land Division Regulations* below)

Proposed modifications to the County Zoning Ordinance should also include provisions for impacts assessment. Land divisions, conditional uses, and other substantial development projects should be required to include an assessment of potential transportation, natural resource, and cost of community service impacts. The level of impacts assessment required should be reasonable and proportional to the intensity of the proposed development. In addition to requesting developers and permit applicants to provide an assessment of these potential impacts, the town should request that multiple site development alternatives are provided as part of the development review process.

Land Division Regulations

Current Status

The Burnett County Subdivision Ordinance applies to the town and requires county approval of land divisions that result in the creation of one or more parcels of five acres or less in size. Refer to Section 9.3 of the *Inventory and Trends Report* for details on existing county ordinances.

Recommended Changes

Land division ordinances will be another key tool that the Town of Dewey will need to utilize to implement its comprehensive plan. For the sake of efficiency and consistency, the town prefers to work with Burnett County to modify the County Subdivision Ordinance for achievement of the town's vision for the future. Similar to the Zoning Ordinance, the town and county must cooperate and coordinate the proposed modifications in accordance with Figure 9-2 to seek the win-win solutions that benefit both parties without negative impact to administration. However, should this approach fall short in implementing the town's plan, the town would consider adopting a local ordinance.

Figure 9-3 Burnett County Comprehensive Planning County/Local Coordinated Decision Making Process

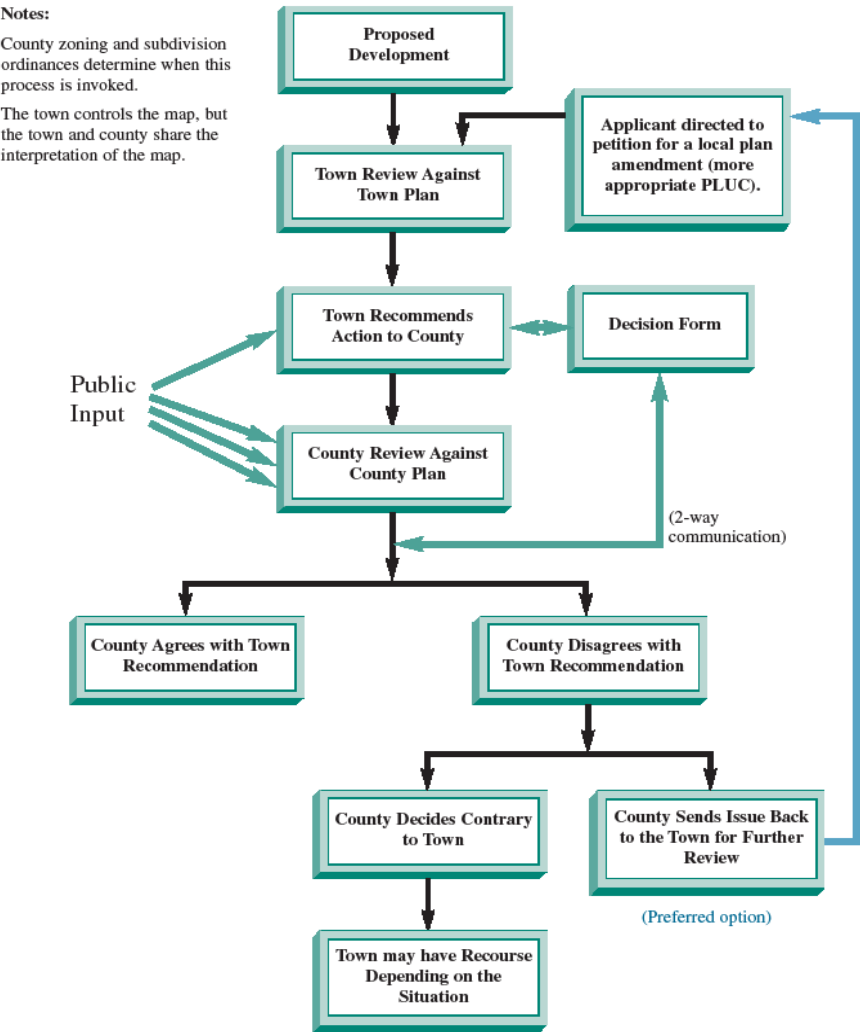

In order to better manage new town roads or other public infrastructure dedications associated with new development, the town should improve subdivision ordinance provisions for the execution of development agreements. A standard development agreement should be assembled that includes provisions for financial assurance, construction warranties, construction inspections, and completion of construction by the town under failure to do so by the developer.

In accordance with Figure 9-3, clear communication between the town and the county is paramount if a shared development review process is to work correctly. It is important to note that the county zoning and subdivision ordinances determine when this process is invoked as the ordinances are administered by Burnett County.

Opportunities for town involvement occur when proposed land uses or land developments require a decision on the part of Burnett County. Such decisions include rezones, conditional uses, and land divisions, and could be expanded to include site plan review. As a town reviews a proposed land use and forwards its decision or recommendation to the county, town decisions should be documented and copied to the county. County decisions should be documented in this same manner and copied to the applicable towns. This process tool gets both units of government using their plans and speaking the same language.

This approach has several advantages. Even if it is the county's position that it will generally follow a town's recommendation, the communication still needs to be clear. The reason for this is because the town and the county are not the only ones involved. The public is also involved, so just agreeing with the town will not eliminate the potential for conflict. And after 2010, the comprehensive planning law makes it even more important that communities clearly document their reasoning when making decisions that should be "consistent" with the comprehensive plan. If a citizen, applicant, developer, etc. challenges a decision of a town or county, they will have a much more difficult challenge winning against the unit of government if the reasoning for a decision is clearly documented and connected to comprehensive plan policies.

Site Plan and Design Review

Current Status

Site plan and design review standards are not currently administered by the town. Refer to Section 9.3 of the *Inventory and Trends Report* for details on related, Burnett County ordinances. Site design refers to the overall layout of the site and the relationship of major features such as buildings, streets, parking and supporting elements.

Recommended Changes

The town does intend to review development applications in conjunction with the Plan Commission. Site planning is not intended to be invasive to the applicant, but is intended to allow the town to manage growth in conjunction with property owners to accomplish town goals. Similar to the zoning and land division ordinance discussions, it is anticipated Burnett County will incorporate basic site design requirements and standards as part of the county code, especially for proposed commercial, industrial, institutional, and multi-family residential developments. This will likely be a cooperative effort with Burnett County, the

surrounding towns, and possibly with incorporated communities as well. Site plan and design review requirements may address the desired characteristics of building layout and architecture, park areas, green space and landscaping, lighting, signage, grading, driveway access, and internal traffic circulation. The example denoted in Figure 9-4 represents a sample of potential considerations associated with site review.

Figure 9-4 Typical Site Design Example

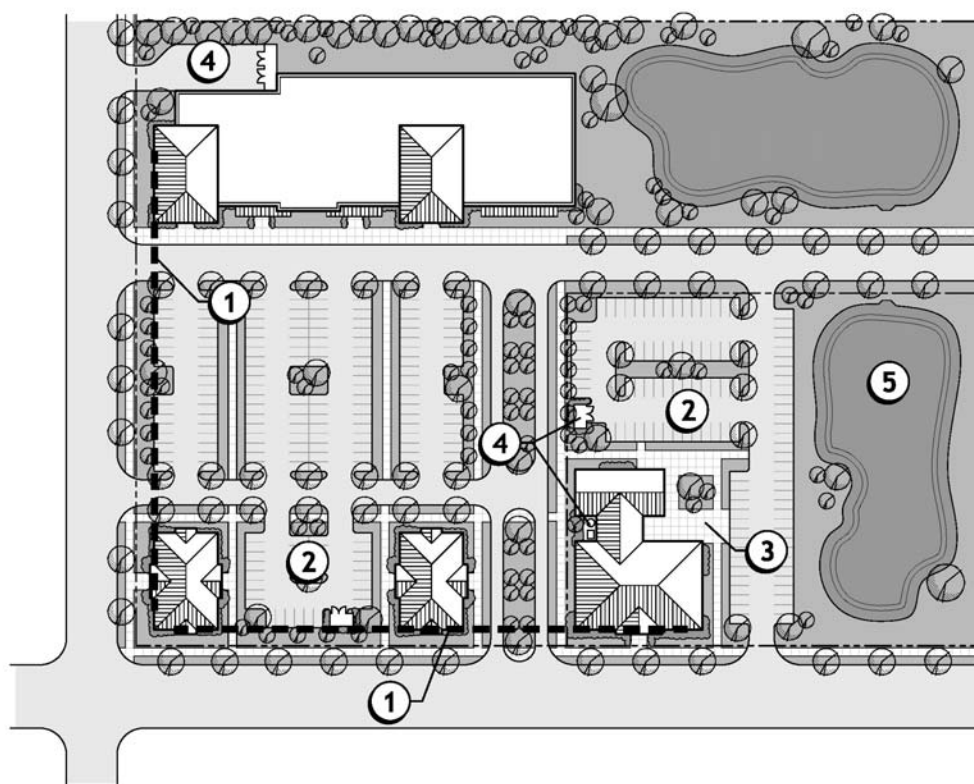

1 Building Location and Setbacks

Buildings should be located to strengthen the definition of street edges and public areas. Building setbacks should also be consistent with those of buildings located on adjacent properties.

2 Parking Lot Configurations and Location

Parking lots should be designed to accommodate convenient vehicular navigation. Generally, two-way drive aisles should be 24 feet wide and non-handicapped accessible spaces should be 9 wide by 18 feet deep. Dead-end aisles should be avoided where possible, but shall include a vehicle turn-around when used.

Parking lots should also be arranged to provide convenient access to buildings and primarily located to the sides or rear and between buildings.

3 Public Space

The integration of public areas including court yards, plazas and gardens into the site is encouraged. These spaces should be defined by surrounding buildings, street edges, landscaping and natural areas.

4 Service/Mechanical/Refuse Location

Service and storage areas, building mechanicals, and refuse/recycling containers should be located so that they are hidden from public view to the greatest extent possible.

5 Storm Water Configuration

Storm water retention and detention areas should be designed to enhance the landscape through the use of natural forms and grading as opposed to rigid geometric shapes.

Additional Standards:

- **Building Elevation Priority** – Building elevations visible from public streets, public spaces, and residential areas shall receive the highest priority for architectural treatment and design treatment.
- **Fences** – Decorative fences made of wood, masonry, stone and ornamental metal are preferred over chain link fences. Chain link fences should be used only when there is a demonstrated security need.
- **Lighting** – Site lighting shall be provided for safety and security and directed away from adjacent properties.

Figure 9-4 represents a sample of what the town/county might assess if a development is proposed. It may not be typical or even necessary that all of the site plan criteria be included on a submitted site plan. Figure 9-4 was included to allow a reference in the need of an advanced development review. In addition, the town/county should seek public input on the establishment of these desired characteristics. The policies of the *Economic Development* element provide some initial guidance on potential design review standards.

Site planning can not only be used to provide for aesthetically pleasing development and protection of valued features of the landscape, but also to ensure that future road extensions will not be blocked by the construction of buildings or other structures. Area development plans will be required of major land divisions and commercial or industrial development proposals. These plans will lay out potential road extensions on adjacent lands. To ensure potential future road connectivity between development sites, the town's policies regarding the use of cul-de-sacs should be included in a revised land division ordinance. Temporary cul-de-sacs

should be limited, but when allowed, should be constructed to the outside property line of the development site.

Official Map Regulations

Current Status

An official map is not currently administered by the town. Refer to Section 9.3 of the *Inventory and Trends Report* for details on related, Burnett County ordinances.

Recommended Changes

Area development planning and site planning will be used to encourage coordinated planning between development sites, but the need for an official map may also develop over the planning period. The town should monitor the need to develop an official map that designates planned, future rights-of-way for roads and utilities in areas of expected growth.

Sign Regulations

Current Status

Sign regulations are not currently administered by the town. Refer to Section 9.3 of the *Inventory and Trends Report* for details on related, Burnett County ordinances.

Recommended Changes

No specific recommendations regarding sign regulations have been identified, however, sign placement and design should be addressed by the site plan and design review ordinance.

Erosion Control and Stormwater Management

Current Status

Erosion control and stormwater management ordinances are not currently administered by the town. Erosion control and stormwater management are addressed by the Burnett County Zoning, Subdivision, Shoreland Zoning, and Non-Metallic Mining Reclamation Ordinances, which are in effect in the Town of Dewey. Refer to Section 9.3 of the *Inventory and Trends Report* for details on related, Burnett County ordinances.

Recommended Changes

The town will modify applicable land division, zoning, and building code ordinances to include improved stormwater management and construction site erosion control requirements. Development proposals will be required to address stormwater management, construction site erosion control, and potential increased risk of flooding in accordance with existing state and county standards.

Historic Preservation

Current Status

Historic preservation ordinances are not currently administered by the town. Refer to Section 9.3 of the *Inventory and Trends Report* for details on related, Burnett County ordinances.

Recommended Changes

The town would like to create a local historic preservation document that recognizes, but does not regulate, historic sites in the town. To support this effort, the town will maintain the map and database of historic and archeological sites and will conduct a community survey of historical and archeological resources at least once every 20 years. Additional research and public outreach are necessary before proceeding with creating such an ordinance.

Building, Housing, and Mechanical Codes

Current Status

Building, housing, and mechanical codes are not currently administered by the town. Refer to Section 9.3 of the *Inventory and Trends Report* for details on related, Waupaca County ordinances.

Recommended Changes

No specific recommendations have been brought forward in regard to creating building, housing, and mechanical codes.

Sanitary Codes

Current Status

The Burnett County Sanitary Ordinance applies to the town. Refer to Section 9.3 of the *Inventory and Trends Report* for details on related Burnett County ordinances.

Recommended Changes

- ♦ No specific changes to sanitary codes are recommended at this time, but the town should continue to work with Burnett County for the regulation of POWTS.

Driveway and Access Controls

Current Status

Driveway and access controls are not currently administered by the town. Refer to Section 9.3 of the *Inventory and Trends Report* for details on related, Burnett County ordinances.

Recommended Changes

The town should adopt a driveway ordinance to implement access control and emergency vehicle access policies as they apply to town roads. The following areas of concern should be addressed by the ordinance.

- ♦ Minimum distance between access points
- ♦ Maximum number of access points per parcel

- ♦ Minimum site distance
- ♦ Minimum driveway surface width and construction materials
- ♦ Minimum clearance width and height
- ♦ Maximum driveway length
- ♦ Minimum turnaround areas for longer driveways
- ♦ Minimum intersection spacing.

Road Construction Specifications

Current Status

Road construction specifications are not currently administered by the town. Refer to Section 9.3 of the Inventory and Trends Report for details on related, Waupaca County ordinances.

Recommended Changes

The town utilizes Wisconsin State Statutes 82.50 which provides minimum standards for roads. The town should develop a set of road construction specifications to include modern requirements for road base, surfacing, and drainage construction. Construction specifications should be adjustable based on the planned functional classification or expected traffic flow of a roadway.

9.3 Non-Regulatory Land Use Management Tools

While ordinances and other regulatory tools are often central in plan implementation, they are not the only means available to a community. Non-regulatory implementation tools include more detailed planning efforts (such as park planning, neighborhood planning, or road improvement planning), public participation tools, intergovernmental agreements, land acquisition, and various fiscal tools (such as capital improvement planning, impact fees, grant funding, and annual budgeting). For basic information on non-regulatory plan implementation tools, please refer to Section 9.2 of the *Inventory and Trends Report*.

The *Town of Dewey Comprehensive Plan* includes recommendations for the use of non-regulatory implementation tools including the following:

- ♦ Assess the availability of land for residential development (*Housing* element).
- ♦ Review ordinances and fees for their impacts on housing (*Housing* element).
- ♦ Pursue funding for needed transportation facilities (*Transportation* element).
- ♦ Utilize intergovernmental efficiencies to provide services and facilities (*Utilities and Community Facilities* element).
- ♦ Assess service and capacity needs including town buildings, staffing, and equipment (*Utilities and Community Facilities* element).

- ♦ Maintain the map and database of historic and archeological sites (*Agricultural, Natural, and Cultural Resources* element).
- ♦ Work with the County on the purchase of development rights and/or a donated easement program (*Agricultural, Natural, and Cultural Resources* element).
- ♦ Support and participate in educational and training programs with local industry, schools, and government (*Economic Development* element).
- ♦ Meet with other units of government (*Intergovernmental Cooperation* element).
- ♦ Review and update the comprehensive plan (*Implementation* element).

9.4 Comprehensive Plan Amendments and Updates

Adoption and Amendments

The Town of Dewey should regularly evaluate its progress toward achieving the goals, objectives, policies, and recommendations of its comprehensive plan. It may be determined that amendments are needed to maintain the effectiveness and consistency of the plan. Amendments are minor changes to the overall plan and should be done after careful evaluation to maintain the plan as an effective tool upon which community decisions are based.

According to Wisconsin's Comprehensive Planning law (Wis. Stats. 66.1001), the same process that was used to initially adopt the plan shall also be used when amendments are made. The town should be aware that laws regarding the amendment procedure may be clarified or changed as more comprehensive plans are adopted, and should therefore be monitored over time. Under current law, adopting and amending the town's comprehensive plan must comply with the following steps:

- ♦ **Public Participation Procedures.** The established public participation procedures must be followed and must provide an opportunity for written comments to be submitted by members of the public to the Town Board and for the Town Board to respond to such comments.
- ♦ **Plan Commission Recommendation.** The Plan Commission recommends its proposed comprehensive plan or amendment to the Town Board by adopting a resolution by a majority vote of the entire Plan Commission. The vote shall be recorded in the minutes of the Plan Commission. The resolution shall refer to maps and other descriptive materials that relate to one or more elements of the comprehensive plan.
- ♦ **Recommended Draft Distribution.** One copy of the comprehensive plan or amendment adopted by the Plan Commission for recommendation to the Town Board is required to be sent to: (a) every governmental body that is located in whole or in part within the boundaries of the town, including any school district, sanitary district, public inland lake protection and rehabilitation district, or other special district; (b) the clerk of every

Village, village, town, county, and regional planning commission that is adjacent to the town; (c) the Wisconsin Land Council; (d) the Department of Administration; (e) the Regional Planning Commission in which the town is located; (f) the public library that serves the area in which the town is located; and (g) persons who have leasehold interest in an affected property for the extraction of non-metallic minerals. After adoption by the Town Board, one copy of the adopted comprehensive plan or amendment must also be sent to (a) through (f) above.

- ♦ **Public Notification.** At least 30 days before the public hearing on a plan adopting or amending ordinance, persons that have requested to receive notice must be provided with notice of the public hearing and a copy of the adopting ordinance. This only applies if the proposed plan or amendment affects the allowable use of their property. The town is responsible for maintaining the list of persons who have requested to receive notice, and may charge a fee to recover the cost of providing the notice.
- ♦ **Ordinance Adoption and Final Distribution.** Following publication of a Class I notice, a public hearing must be held to consider an ordinance to adopt or amend the comprehensive plan. Ordinance approval requires a majority vote of the Town Board. The final plan report or amendment and adopting ordinance must then be filed with (a) through (f) of the distribution list above that received the recommended comprehensive plan or amendment.

Updates

Comprehensive planning statutes require that a comprehensive plan be updated at least once every 10 years. However, it is advisable to conduct a plan update at a five year interval. An update requires revisiting the entire planning document. Unlike an amendment, an update is often a substantial re-write of the text, updating of the inventory and tables, and substantial changes to maps, if necessary. The plan update process should be planned for in a similar manner as was allowed for the initial creation of this plan including similar time and funding allotments. State statutes should also be monitored for any modified language.

9.5 Integration and Consistency of Planning Elements

Implementation Strategies for Planning Element Integration

While this comprehensive plan is divided into nine elements, in reality, community planning issues are not confined to these divisions. Planning issues will cross these element boundaries. Because this is the case, the policies and recommendations of this plan were considered by the Town of Dewey in the light of overall implementation strategies. The following implementation strategies were available for consideration.

Housing <ol style="list-style-type: none"> 1. Create a range of housing options 2. Create opportunities for siting of quality affordable housing 3. Change the treatment of mobile and manufactured homes 	Economic Development <ol style="list-style-type: none"> 1. Change community conditions for attracting business and job growth 2. Change community conditions for retaining existing businesses and jobs 3. Create additional tax base by requiring quality development and construction 4. Create more specific plans for economic development
Transportation <ol style="list-style-type: none"> 1. Create efficiencies in the cost of building and maintaining roads (control taxes) 2. Preserve the mobility of collector and/or arterial roads 3. Create safe emergency vehicle access to developed properties 4. Create improved intersection safety 5. Create more detailed plans for transportation improvements 6. Create road connectivity 7. Create bicycle and pedestrian options 	Intergovernmental Cooperation <ol style="list-style-type: none"> 1. Create intergovernmental efficiencies for providing services and facilities 2. Create a cooperative approach for planning and regulating development along community boundaries 3. Preserve intergovernmental communication
Utilities and Community Facilities <ol style="list-style-type: none"> 1. Create efficiencies in the cost of providing services and facilities (control taxes) 2. Create more detailed plans for facility and service improvements 3. Create intergovernmental efficiencies for providing services and facilities 4. Create improved community facilities and services 5. Preserve the existing level and quality of community facilities and services 6. Preserve the quality of outdoor recreational pursuits. 7. Create additional public recreation facilities 8. Create opportunities to maximize the use of existing infrastructure 	Land Use <ol style="list-style-type: none"> 1. Preserve the existing landscape by limiting growth 2. Preserve valued features of the landscape through site planning 3. Preserve development rights 4. Create an overall pattern of growth that is dispersed 5. Create an overall pattern of growth that is clustered 6. Create an overall pattern of growth that is concentrated 7. Preserve the influence of market forces to drive the type and location of development 8. Create a system of development review that prevents land use conflicts 9. Create a system of development review that manages the location and design of non-residential development
Agricultural, Natural, and Cultural Resources <ol style="list-style-type: none"> 1. Preserve agricultural lands 2. Preserve the right to farm 3. Preserve active farms 4. Preserve natural resources and/or green space 5. Preserve rural character 6. Create targeted areas for farming expansion 7. Create targeted areas for forestry expansion 8. Preserve historic places and features 	

These overall strategies are grouped by element, but are associated with goals, objectives, policies and recommendations in multiple elements.

Wisconsin's Comprehensive Planning law requires that the *Implementation* element describe how each of the nine elements of the comprehensive plan will be integrated with the other elements of the plan. The implementation strategies provide planning element integration by grouping associated policies and recommendations in multiple elements with coherent, overarching themes.

The Town of Dewey selected from the available strategies to generate its policies and recommendations. The selected implementation strategies reflect the town's highest priorities for implementation, and areas where the town is willing to take direct implementation responsibility. Each planning element has very detailed goals and objectives that set the course of action, followed and supported by detailed and specific policies and recommendations that enable the goal fulfillment. The goals, objectives, policies and recommendations represent the selected strategies the town felt were important enough to focus on over the planning period.

Planning Element Consistency

Wisconsin's Comprehensive Planning law requires that the *Implementation* element describe how each of the nine elements of the comprehensive plan will be made consistent with the other elements of the plan. The planning process that was used to create the *Town of Dewey Year 2030 Comprehensive Plan* required all elements of the plan to be produced in a simultaneous manner. No elements were created independently from the other elements of the plan, therefore reducing the threat of inconsistency.

There may be inconsistencies between the goals and objectives between elements or even within an individual element. This is the nature of goals and objectives. Because these are statements of community values, they may very well compete with one another in certain situations. The mechanism for resolving any such inconsistency is the policy statement. Where goals or objectives express competing values, the town should look to the related policies to provide decision making guidance. The policies established by this plan have been designed with this function in mind, and no known policy inconsistencies are present between elements or within an individual element.

Over time, the threat of inconsistency between the plan and existing conditions will increase, requiring amendments or updates to be made. Over time, additional plans regarding specific features within the community may also be developed (e.g., outdoor recreation plan, downtown development plan, etc.). The process used to develop any further detailed plans should be consistent with this *Town of Dewey Year 2030 Comprehensive Plan*.

9.6 Measurement of Plan Progress

Wisconsin's Comprehensive Planning law requires that the *Implementation* element provide a mechanism to measure community progress toward achieving all aspects of the comprehensive plan. An acceptable method is to evaluate two primary components of the plan, policies and recommendations, which are found in each plan element.

To measure the effectiveness of an adopted policy, the community must determine if the policy has met the intended purpose. For example, the Town of Dewey has established a Transportation element policy that states, “Dead-end roads and cul-de-sacs shall be avoided to the extent practicable and allowed only where physical site features prevent connection with existing or planned future roadways.” To determine whether the policy is achieving the community’s intention a “measure” must be established. In the case of this policy, the measure is simply how many dead-end roads or cul-de-sacs have been constructed since the plan’s adoption, and how many of those were necessitated by the site conditions. Each policy statement should be reviewed periodically to determine the plan’s effectiveness.

Likewise, recommendations listed within each element can be measured. For recommendations, the ability to “measure” progress toward achievement is very straight forward in that the recommendations have either been implemented or not.

To ensure the plan is achieving intended results, periodic reviews should be conducted by the Plan Commission and results reported to the governing body and the public.

9.7 Implementation Goals and Objectives

Community goals are broad, value-based statements expressing public preferences for the long term (20 years or more). They specifically address key issues, opportunities, and problems that affect the community. Objectives are more specific than goals and are more measurable statements usually attainable through direct action and implementation of plan recommendations. The accomplishment of objectives contributes to fulfillment of the goal.

Goal 1: Promote consistent integration of the comprehensive plan policies and recommendations with the ordinances and implementation tools that affect Burnett County.

Objectives:

- A. Update and/or revise the comprehensive plan on a regular schedule (at least every ten years) to ensure that the plan remains a useful guide for land use decision making.
- B. Require that administration, enforcement, and implementation of land use regulations are consistent with the Burnett County comprehensive plan or municipal plans, where applicable.
- C. Develop and update as needed an “Action Plan” as a mechanism to assist the County Land Use and Information Committee and County Board to bring implementation tools into compliance with the comprehensive plan.

Goal 2: Balance appropriate land use regulations and individual property rights with community interests and goals.

Objectives:

- A. Provide continuing education to the public that will lead to a more complete understanding of planning and land use issues facing the County.
- B. Create opportunities for citizen participation throughout all stages of planning, ordinance development, and policy implementation.
- C. Maintain an implementation tool development review process whereby all interested parties are afforded an opportunity to influence the outcome.
- D. Maintain a land use (agricultural, industrial, commercial, and residential) development review process whereby all interested parties are afforded an opportunity to influence the outcome.

9.8 Implementation Policies and Recommendations

Policies and recommendations build on goals and objectives by providing more focused responses to the issues that the town is concerned about. Policies and recommendations become primary tools the town can use in making land use decisions. Many of the policies and recommendations cross element boundaries and work together toward overall implementation strategies. Refer to Section 9.5 for an explanation of the strategies cited as sources for many of the policies and recommendations.

Policies identify the way in which activities are conducted in order to fulfill the goals and objectives. Policies that direct action using the word “shall” are advised to be mandatory and regulatory aspects of the implementation of the comprehensive plan. In contrast, those policies that direct action using the words “will” or “should” are advisory and intended to serve as a guide. “Will” statements are considered to be strong guidelines, while “should” statements are considered loose guidelines.

Recommendations are specific actions or projects that the town should be prepared to complete. The completion of these actions and projects is consistent with the town’s policies, and therefore will help the town fulfill the comprehensive plan goals and objectives.

Policies and Recommendations

1. The county shall maintain the comprehensive plan as an effective tool for the guidance of county governance, and will update the plan as needed to maintain consistency with state comprehensive planning requirements.
2. County policies, ordinances, and decisions relative to zoning, land divisions and subdivisions, shoreland and shoreland-wetland zoning, and official mapping shall be made in conformance with the comprehensive plan.
3. Maintain funding for continued provision of professional planning services toward the implementation of county and local comprehensive plans. The county should consider creating a county planning department and appropriate staff, work directly with the NWWRPC, or retain a consultant for these services. Consider local cost-sharing, user-fees, grants, and other methods as potential funding sources.

4. Develop and maintain an action plan that identifies specific projects that are to be completed toward the implementation of the comprehensive plan. An action plan identifies an estimated time frame and responsible parties for each project or action.
5. The action plan located within the comprehensive plan will be updated when tasks are accomplished and new items will be added when appropriate.
6. Review the comprehensive plan annually (in conjunction with the county budgeting process) for performance on goals, objectives, policies, and recommendations, for availability of updated data, and to provide an opportunity for public feedback. This review does not need to be as formal as the comprehensive review required at least every 10 years by Ch. 66.1001, Wisconsin Statutes.
7. The county shall revise or amend its comprehensive plan no more than four (4) times per year.
8. When the comprehensive plan is updated with new census data, data that indicate significant change within the ten year period will be re-examined and evaluated and necessary strategies to address the issue will be amended to the plan.
9. The county Zoning Committee has the responsibility to review and make a recommendation on any proposed amendments to the zoning ordinance, official map, shoreland zoning ordinance and subdivision ordinance, etc. affecting the county.
10. State of Wisconsin Comprehensive Planning statutes will be monitored by an assigned official to ensure that statute changes, additions or deletions are appropriately accounted for with respect to the community comprehensive plan.
11. If the county should experience substantial land use or land use regulation changes within the planning period, maps which represent these features will be updated to ensure the most accurate information is utilized in community decision making.
12. Maps will be used in coordination with established county goals and objectives to ensure the consistency between the comprehensive plan's text as well as maps and/or other graphics.
13. Every five years the county will evaluate the availability of funds for updating the comprehensive plan. If adequate funds are not available then a strategy will be developed to ensure that sufficient funds are available for a comprehensive plan update.
14. Areas of the plan which are likely to be disputed or litigated in the future should be reviewed by Corporation Counsel to ensure his or her knowledge of the plan and to offer suggestions to reduce conflict.
15. The annual review of the comprehensive plan will be done in a committee format with public involvement including citizens, landowners, community officials and staff to evaluate the plan in an un-biased manner.